

# LIVING&CO



## CARPET CLEANER

Model Number: IA0850



### INSTRUCTION MANUAL

---

AFTER SALES SUPPORT

☎ 0800 824 556 📧 [service@unclebills.com.au](mailto:service@unclebills.com.au)

# Contents

- 03 General Information and Safety Instructions
- 06 Product Overview
- 07 Getting Started
- 09 Instructions
- 12 Cleaning, Care and Maintenance
- 14 FAQ
- 15 Other Useful Information
- 16 Warranty Information

# General Information and Safety Instructions

Read this manual thoroughly before first use, even if you are familiar with this type of product. The safety precautions enclosed herein reduce the risk of fire, electric shock and injury when correctly adhered to. Please keep this user manual in a safe place along with your purchase receipt and carton for future reference. If applicable, pass these instructions and packaging on to the next owner of the appliance. Always follow basic safety precautions and accident prevention measures when using an electrical product.

## Electrical Safety and Cord Handling

**IMPORTANT:** Never pull by the cord. To disconnect from the power supply, remove the plug from the power outlet.

1. Before turning on the Carpet Cleaner, ensure the electrical voltage and frequency of the circuit corresponds to those indicated on the rating label of the product.
2. To protect against fire and electric shock, do not immerse the product, cord set or plug in water or any other liquid.
3. Do not use an extension cord unless completely necessary with the Carpet Cleaner. If an extension cord is used, please ensure that it has a rating equal or exceeding the rating of this product.
4. Do not pull or carry by cord, use cord as a handle, close a door on the cord, or pull cord around sharp edges or corners. Keep cord away from heated surfaces.
5. Do not bend or damage the power cord.
6. Never force the plug into an outlet.
7. Always unplug the Carpet Cleaner when not in use. To disconnect from the power supply, grip the plug and pull from the power outlet. Never pull by the cord. The plug must be removed from the power outlet before cleaning, servicing, maintenance or moving the Carpet Cleaner.
8. To avoid a hazard, do not use the Carpet Cleaner if the plug, cord or the Carpet Cleaner itself is damaged. Please contact the After Sales Support line for further advice.
9. Do not run over the cord with the Carpet Cleaner.
10. Unless your home is already fitted with a residual current device (safety switch), we recommend installing an RCD with a rated residual operating current not exceeding 30 mA to provide additional safety protection when using electrical appliances. See your electrician for professional advice.
11. Do not handle the plug, cord or the Carpet Cleaner with wet hands.
12. If the supply cord is damaged it must be replaced by the manufacturer, its service agent or similarly qualified persons in order to avoid a hazard.

# General Information and Safety Instructions (cont)

## Usage Conditions and Restrictions

1. The Carpet Cleaner is intended for indoor household use only and not for commercial purposes.
2. Do not use the Carpet Cleaner for any other purpose than its intended use.
3. The Carpet Cleaner is not a toy. Supervise young children to ensure they do not play with this product.
4. The Carpet Cleaner is not intended for use by persons (including children) with reduced physical, sensory or mental capabilities or lack of experience or knowledge, unless they have been given supervision or instruction concerning use of the product by a person responsible for their safety.
5. Do not leave the Carpet Cleaner unattended when plugged in. Always switch off and unplug when you are not using the Carpet Cleaner.
6. This unit has no user-serviceable parts contained within. Do not attempt to repair, disassemble or modify the Carpet Cleaner.
7. Improper installation or misuse may result in the risk of fire, electric shock or injury to person.
8. The manufacturer is not responsible for any eventual damage caused by improper or faulty use.
9. The use of attachments not sold or recommended by the manufacturer may cause fire, electric shock or injury.
10. The Carpet Cleaner is not intended to be operated by means of an external timer or any type of separate remote control system.
11. Keep the Carpet Cleaner on the floor while operating.
12. To reduce the risk of electric shock, do not use outdoors.

# General Information and Safety Instructions

## (cont)

### Handling and Usage

1. To reduce the risk of electrocution, never operate this product with wet hands, submerge in water or spill liquids into the product.
2. Do not use the Carpet Cleaner near a window as rain may cause electric shock.
3. Do not put any objects into the openings of the Carpet Cleaner or operate when the openings are blocked. Keep the openings free of anything that may reduce the airflow.
4. Do not use the Carpet Cleaner on any glowing, burning or smoking particles.
5. Do not use the Carpet Cleaner without the clean/waste water tank.
6. Do not use to pick up flammable or combustible liquids such as petrol, or use where they may be present.
7. Do not attempt to remove blockages with sharp objects as this may cause damage to the Carpet Cleaner.
8. Do not hold the Carpet Cleaner upside down or lay on its side, doing so may cause waste water to run into the motor. Use the appliance in an upright position.
9. Use extra care when using the Carpet Cleaner on stairs.
10. Do not carry the Carpet Cleaner while the motor is still on.
11. Keep hair, loose clothing, fingers and all parts of body away from the openings or moving parts.
12. Do not use to pick up any liquid other than cleaning solution and water dispensed from this machine.
13. Do not expose the Carpet Cleaner to rain.
14. Carpets should be dry vacuumed thoroughly before cleaning.
15. Cleaning filters maintains cleaning performance. Ensure filters are completely dry before inserting back into the machine.

# Product Overview

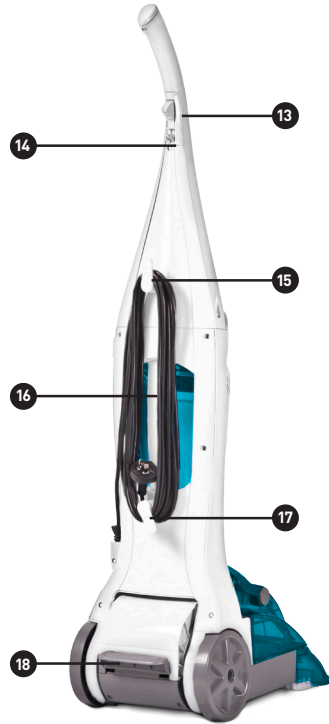
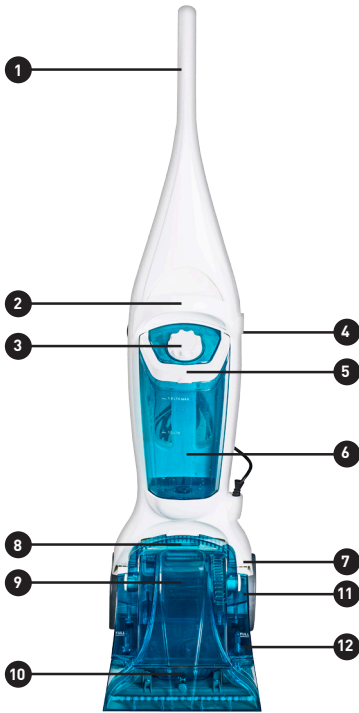

1. Handle
2. Carry Handle
3. Clean Water Tank Cap
4. ON/OFF Switch
5. Clean Water Tank Release Handle
6. Clean Water Tank
7. Waste Water Tank Locking Latch
8. Waste Water Tank Handle
9. Inlet Filter (not visible when waste water tank is fitted)
10. Scrubbing Brush
11. Exhaust Filter
12. Waste Water Tank
13. Clean Water Release Trigger
14. Power Cord Tidy
15. Upper Power Cord Holder
16. Power Cord
17. Lower Power Cord Holder
18. Handle Release Pedal

Included (not pictured):  
Assembly screws and Instruction Manual.

# Getting Started

## Before First Use

Prior to using your Carpet Cleaner, please read all the safety and operating instructions thoroughly. Please ensure you follow the steps below before using this appliance. We recommend you keep the original packaging for storing your Carpet Cleaner when not in use.

1. Unpack the product but keep all packaging material until you have made sure your new Carpet Cleaner is undamaged and in good working order. Plastic wrapping can be a suffocation hazard for babies and young children, so ensure all packaging materials are out of their reach.
2. Remove the twist-tie which is securing the electrical cord. Uncoil the cord and straighten it to remove any kinks. Do not use this product if these parts are damaged. In case of damage, phone the After Sales Support Line.

## Assembly

The Carpet Cleaner comes in two pieces (top part with handle and trigger, and bottom part being the rest of the body) which makes assembling quick and easy.

1. Place the body of the Carpet Cleaner in an upright position.
2. Align the handle to the grooves on the body of the Carpet Cleaner.
3. Once handle is in place, secure to the body of the Carpet Cleaner with the 2 screws supplied. See Fig. 1.

**NOTE:** Do not plug the cord into a power outlet until the Carpet Cleaner is fully assembled.

**CAUTION:** Do not over tighten the screws as this will thread the holes. Do not operate the Carpet Cleaner without the handle securely screwed into place.

Fig. 1

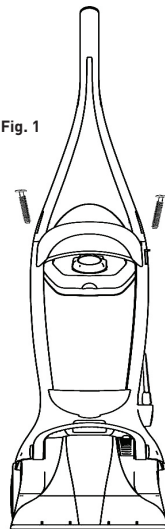

# Getting Started (cont)

## Carpet Preparation

Before cleaning your carpets, here are some steps to help you prepare the area to be deep cleaned.

1. Move the furniture from the room to be cleaned (optional).
2. Using a dry vacuum cleaner, vacuum the area to be deep cleaned.

**NOTE:** The Carpet Cleaner can also be used without carpet cleaning solution. Water alone can also clean your carpets.

3. For high traffic areas such as entry and hallways, a commercial pre-treater can be used (optional).
4. Plan your cleaning route, it is recommended to begin cleaning in the corner furthest away from your exit point.

## Check for Colour Fastness

Before cleaning your carpets, it is recommended to do a patch test for colour fastness.

1. Dampen a white cloth with water and gently rub a small area to be cleaned which is out of sight.
2. Check the cloth for bleeding, if the cloth remains clean, it is safe to clean the carpets.



# Instructions

## Preparing the Carpet Cleaner for Use

1. Remove the clean water tank from the Carpet Cleaner and fill with water. To remove, lift the clean water tank release handle up and pull away from the Carpet Cleaner. See Fig. 2 and 3.
2. Unscrew the clean water tank cap and add 1 capful of your desired carpet cleaning solution (not included). Only use 1 capful of cleaning solution per tank.
3. Fill the rest of the clean water tank with warm water (max 40°C) and replace the clean water tank cap.

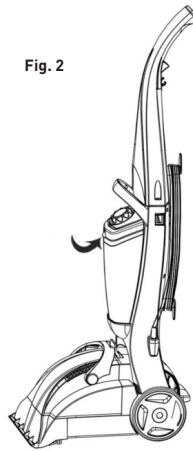

Fig. 2

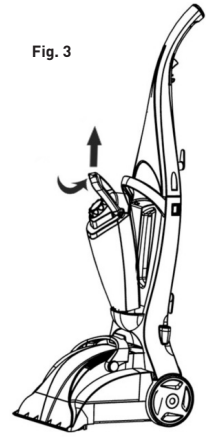

Fig. 3

**NOTE:** The Carpet Cleaner can also be used without carpet cleaning solution. Water alone can also clean your carpets.

**NOTE:** Only use low foam carpet cleaning solutions as using the incorrect solution may cause excess foaming. Excess foam will prevent the machine from working effectively. It is also recommended to purchase anti-foam solution to add to the waste water tank to prevent excess foaming. Please follow the recommended usage quantity listed on the bottle. These are both available from all good hardware and DIY outlets as well as professional carpet cleaning stores.

**CAUTION:** Do not use any solvents, cleaners with strong acidic or strong alkali formulas or any type of cleaning solution not specifically for use in carpet extraction cleaning machines.

**CAUTION:** Keep carpet cleaning solution out of reach of children. In case of contact with eyes, rinse immediately with plenty of water and seek medical advice. As with all detergents, people with sensitive or damaged skin should avoid prolonged contact with the product. See carpet cleaning solution packaging for more instructions.

4. Return the clean water tank back into the original position within the Carpet Cleaner. To lock and secure, push the clean water tank back and press down on the handle until both the handle and the water tank clicks into place.

**CAUTION:** Do not use the Carpet Cleaner if the clean water tank is not securely in position.

# Instructions (cont)

## Using the Carpet Cleaner

The Carpet Cleaner uses water, cleaning solution and the sturdy floor brushes to loosen embedded dirt from the carpet. The Carpet Cleaner then removes this dirt and collects it in the waste water tank.

1. Plug the cord into a power outlet and switch on at the outlet.
2. To turn the Carpet Cleaner ON, press the O/I switch to the "I" position.
3. Step on the release pedal to lower the Carpet Cleaner into the cleaning position. See Fig. 4.
4. While pressing the water release trigger, pull the Carpet Cleaner in a backwards motion. Water and solution will only be released when pressing this trigger. Let go of the water release trigger and push the Carpet Cleaner forward on the same path to loosen and remove waste water and solution from the carpet. For heavy soiled areas, repeat if necessary. When the Carpet Cleaner has been powered on, the vacuum will continually operate until powered off.

Fig. 4

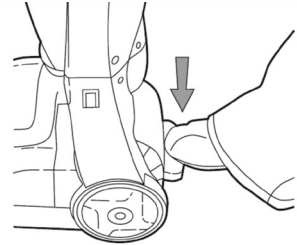

**NOTE:** For best cleaning results, use a steady, moderate, forward and backward motion. Always work from backward and forward, across the room to avoid stepping on the wet carpet.

**NOTE:** Do not over saturate the carpet with solution while using the Carpet Cleaner.

5. Once you have finished cleaning, turn the Carpet Cleaner OFF. Press the O/I switch to the "O" position.

**NOTE:** Allow for the carpet to completely dry before walking on. If necessary to walk on, place a towel on the area to be walked on.

**NOTE:** Wipe the cleaning solution from any door frames or furniture to prevent damage.

**NOTE:** The Carpet Cleaner may leave a small pool of solution in the location that it was turned off. This is normal and the excess solution can be wiped away with a white, soft cloth. This can be minimised by releasing the water release trigger and then carrying out one more back and forward cycle before switching OFF. This will flush out most of the residual solution left in the tubes.

# Instructions (cont)

## Emptying the Waste Water Tank

The Carpet Cleaner is fitted with an automatic shut off which prevents the extractors from picking up and over filling the waste water tank. Here are a couple of indications of when you may need to empty the waste water tank:

The motor sound rises in pitch.

You do not see any more water coming through the waste water tank.

The water inside the waste water tank has risen to the top of the tank and is visible through the clear tank.

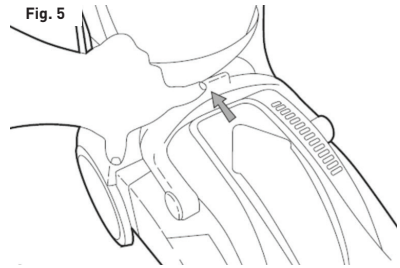

## How to Remove the Waste Water Tank

1. Turn off the Carpet Cleaner by pressing the O/I switch to the "O" position.
2. Push the waste water tank latch backwards to release the handle, then remove the waste water tank by pulling the handle up and towards you. See Fig. 5.
3. Remove the cap on the waste water tank and discard the waste water within, then rinse out the waste water tank with warm water. Replace the cap, ensuring the cap is in the lock position. See Fig. 6.
4. Return the waste water tank back to its original position. To secure, push the handle back until it locks into position with the waste water tank latch (you will hear a loud click).

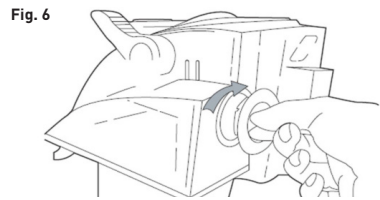

# Cleaning, Care and Maintenance

1. Switch off and unplug the Carpet Cleaner at the power outlet.
2. Remove the clean water tank and discard any water remaining within the tank. Rinse with warm water (40°C max) to clean.
3. Remove the waste water tank and discard any waste water within the tank. Rinse with warm water (40°C max) to clean.
4. If necessary, remove any hair or large pieces of debris from the scrubbing brush.
5. Clean the exterior of the Carpet Cleaner using a soft damp cloth and dry thoroughly.

**NOTE:** Do not leave water in either of the water tanks. Mineral deposits and mildew can form which will affect performance of the Carpet Cleaner.

## Cleaning the Filters

1. The exhaust filter is found in the waste water tank. Remove the exhaust filter by pressing down the latch then pulling the waste water tank handle fully forward to expose the exhaust filter latch. Pull the exhaust filter latch forward to release, then pull out the exhaust filter forward and left to remove. See Fig. 7.
2. Remove the filter sponge from the filter and rinse with water to remove all the dust, dirt and particles. Allow to dry thoroughly before replacing back into the waste water tank. See Fig. 8 and 9.
3. The filter inlet sponge is found in the bottom on the Carpet Cleaner, under the waste water tank. To access it, first remove the waste water tank. Pull out the filter inlet sponge, then rinse, then rinse with warm water to clean off any dirt that has become attached. Allow it to dry thoroughly before replacing back into position in the Carpet Cleaner. See Fig. 10.

**NOTE:** If for some reason you need a new filter sponge or filter inlet sponge, do not return this product to place of purchase. Instead, please call the After Sales Support Line for a replacement filter.

Fig. 7

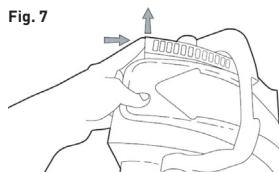

Fig. 8

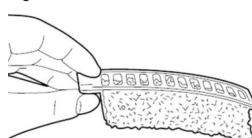
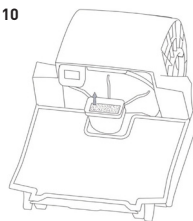

Fig. 9



Fig. 10



# Cleaning, Care and Maintenance (cont)

## After Cleaning

After you have finished cleaning your carpet, here are a few tips to follow.

- Allow the carpet to dry completely, and try not to walk on it.
- If it is necessary to walk on the carpet, place some towels on the area to walk on.
- If the carpet is not completely dry and furniture must be placed back into the room cleaned, place plastic under the furniture to prevent the carpet from getting stained.
- Thoroughly clean the waste water tank with warm (MAX 40°C) tap water once you have finished cleaning.
- To assist with the drying process, increase the air circulation by setting up fans to blow across the area cleaned and leave doors and windows open.

## Storage

- Before packing away the Carpet Cleaner for storage, ensure it is clean and dry.
- We recommend storing the Carpet Cleaner in its original carton to protect it from dust, with all the parts and accessories.
- Store the Carpet Cleaner in a clean and dry place, out of children's reach.
- Do not place heavy objects on top during storage.

**NOTE:** If you wish to enquire about purchasing spare parts for your Carpet Cleaner please contact 0800 824 556.

# FAQ

Problem	Solution
Why is the Carpet Cleaner not working?	<ul style="list-style-type: none"><li>• Check you have plugged the cord into the power outlet correctly and that it is switched on.</li><li>• Check you have pressed the ON/OFF switch to the "I" position.</li><li>• Check if the waste water tank is full and if so, empty it.</li></ul>
Why isn't there any water spraying from the Carpet Cleaner?	<ul style="list-style-type: none"><li>• Check there is water and solution inside the clean water tank.</li></ul>
Why is the Carpet Cleaner not picking up the water and solution?	<ul style="list-style-type: none"><li>• Check that you have fitted the waste water tank correctly.</li><li>• Check if the waste water tank is full and if so, empty it.</li></ul>
Why is there liquid escaping from the Carpet Cleaner?	<ul style="list-style-type: none"><li>• Check if the waste water tank is full, and if so, empty it.</li><li>• Prior to switching OFF the Carpet Cleaner, release the clean water release trigger and carry out one back and forward cycle before switching OFF. This will flush out any residual solution left in the tubes.</li></ul>

# Other Useful Information

## Responsible Disposal

At the end of its working life, do not throw this product out with your household rubbish. Electrical and electronic products contain substances that can have a detrimental effect on the environment and human health if disposed of inappropriately. Observe any local regulations regarding the disposal of electrical consumer goods and dispose of it appropriately for recycling. Contact your local authorities for advice on recycling facilities in your area.

Please keep the original packaging carton and materials in a safe place. It will help to prevent any damage if the product needs to be transported in the future. In the event it is to be disposed of, please recycle all packaging material where possible.

If you require another copy of this instruction manual please contact [service@unclebills.com.au](mailto:service@unclebills.com.au) to obtain an electronic copy.

The Carpet Cleaner has been fully tested and meets all requirements as set out by the below testing standards:

AS/NZS 60335.1  
AS/NZS 60335.2.2  
AS/NZS CISPR14.1

## Specification Table

MODEL:	IA0850
COLOUR:	White and Blue
VOLTAGE:	220-240V~ 50-60Hz Class II IPX4
POWER:	600W
DIMENSIONS:	115 x 26 x 42cm
NET WEIGHT:	6.0kgs
WARRANTY:	12 Months

VOLUME OF CLEAN WATER TANK:	1.8L
VOLUME OF WASTE TANK:	2.45L
LENGTH OF POWER CORD:	6m

# Warranty Information

## Conditions of Warranty

This Living & Co Carpet Cleaner is warranted to be free from defects in material and workmanship under normal use and service conditions for a period of 1 year from the date of purchase of this article. Evidence of unfair usage or incorrect adjustment by the owner will void this promise. Defects that occur within this warranty period, under normal use and care, will be repaired, replaced or refunded at our discretion.

All warranty coverage extends only to the original retail purchaser from the date of purchase. Please keep your receipt, tax invoice or other proof of purchase.

It is recommended that our Service Centre is contacted before returning the product back to store. In many cases, the problem can be resolved over the phone and a return to store may not be necessary.

If there is a major fault and the Service Centre has not been able to solve the problem, please return the product along with the receipt, to the store you purchased it from.

## SERVICE CENTRE

### Uncle Bill's Service Centre:

2/24 Anderson Road, Smeaton Grange, NSW, 2567, Australia – if mailing please include your contact details.

Contact details and hours of operation.

Phone 0800 824 556

Email [service@unclebills.com.au](mailto:service@unclebills.com.au)

9:00am – 4:30pm Monday to Friday (excluding Public Holidays) - AEST

9:00am – 3:00pm Saturday - AEST

This appliance is warranted and imported by:

Uncle Bill's (Australia) Pty Ltd

48B Egerton Street

Silverwater NSW 2128, Australia

Phone: 02 8799 3500





UNCLE BEN'S MILLS



**Carpet Cleaner**

Artwork Size: 148 x 152mm

PLU #: 53602

Item Code #: IA0850

On Sale Date: 06/2016

**ALDI AMENDMENTS: D**

DATE: 29-11-2016

UB MODIFIED: Ben (Format)



**C M Y K**

**ARTWORK SIGN OFF**

\_\_\_\_\_  
SIGNATURE

\_\_\_\_\_  
SIGNATURE

**PRINTER FILE**



**DO NOT PRINT**  
**不要打印**