

Responsible Disposal

At the end of its working life, do not throw this product out with your household rubbish. Electrical and electronic products contain substances that can have a detrimental effect on the environment and human health if disposed of inappropriately. Observe any local regulations regarding the disposal of electrical consumer goods and dispose of it appropriately for recycling. Contact your local council for advice on recycling facilities in your area. Please keep the original packaging carton and materials in a safe place. It will help to prevent any damage if the product needs to be transported in the future. In the event it is to be disposed of, please recycle all packaging material where possible.



living & co.

Warranty
We pride ourselves on producing a range of quality products that are both packed with features and completely reliable. We are so confident in our products, we back them up with a 1 year warranty.
Now you too can relax knowing that you are covered. Customer Helpline NZ: 0800 422 274
This Product is covered by a 1 year warranty when accompanied by proof of purchase.

IM version 1.0 October 2024

living & co.

AFTER SALES SUPPORT
☎ 0800 422 274

living & co.
LED RECHARGE TOUCH LAMP

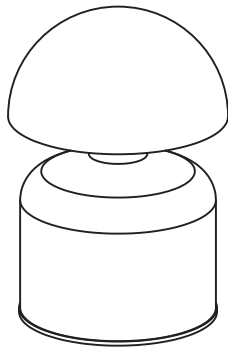

Instruction Manual
MODEL NO. 5783-T340

living & co.

AFTER SALES SUPPORT
☎ 0800 422 274

6
WARNINGS

When using this product, below safety precautions should always be followed.

- Do not immerse in water or any other liquid.
- Do not put the product near fire or flammable sources.
- Charge the battery with a DC5V Output via a USB power supply (not included).
- Disconnect the USB cable from the product when it is fully charged or no longer in use.
- Disconnect from the USB power supply and cease to use the product immediately if it begins to show visible smoke or give off unusual smells during the charging process.
- This product is NOT a toy. Keep out of reach of small children. Young children should be supervised to ensure that they do not play with this product.
- Do not use the product with a damaged USB cable or charger (not included). Warning: Never use the product with damaged casing.
- Do not handle the product with wet hands whilst it is being charged or connected to a power source.
- When disconnecting, grip the USB charger (not supplied) and pull it from the socket.
- Never pull by the cable. Always keep the attached cable away from sharp edges in use or when removing.
- Do not immerse the USB cable or charger (Not Supplied) in water or any other liquid.
- Do not charge with a damaged charger, or when the product malfunctions or is damaged in any manner.
- Do not allow children to play with the packaging materials.
- Warning : The light source and battery of this luminaire is not replaceable; when the light source and battery reaches its end of life, the whole luminaire should be replaced. Do not attempt to open the casing.

WARNING

This product has not been designed for any uses other than specified in this booklet.

living & co.

AFTER SALES SUPPORT
☎ 0800 422 274

3
INTRODUCTION

Congratulations on your purchase of this product. Please read the instruction manual carefully before using the lamp. This manual contains important information for your safety and will assist with correct understanding for operation and installation/ assembly of the floor lamp.

Keep this instruction manual safe for future reference.

Technical Data

Input	DC 5V 1A
Cable length	1m
Rechargeable battery	Li-ion 3,7V 1200 mAh Li-ion
Charge time	2 hrs
Run time	3-4 hrs (Full charge)

NOTE: As a result of continual improvements, the design and specifications of the product within may differ slightly to those illustrated on the packaging.

living & co.

AFTER SALES SUPPORT
☎ 0800 422 274

Contents

- 03 INTRODUCTION
- 04 ASSEMBLY AND OPERATION
- 05 OPERATION DESCRIPTION, CARE AND MAINTENANCE
- 06 WARNING

living & co.

AFTER SALES SUPPORT
☎ 0800 422 274

4
ASSEMBLY AND OPERATION

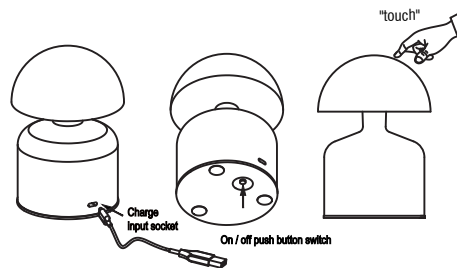

How to use the Lamp

1. Remove all parts from the packaging.
 2. **Lamp button** on the lamp base.
 3. **Charging:** Plug the connector from the charging cable into the corresponding input socket of the Light. Plug the standard USB connector into the corresponding port of a USB charger (not included), with a 5V DC output USB port. When charging the lamp and the battery has low or partial charge, the charge indicator light will illuminate Red. When fully charged, the charge indicator light will illuminate Green.
Fully charge the Lamp. This typically takes 2 hours.
Note: To extend the life of the battery, always recharge the lamp after use.
- Note 1: The charge indicator is visible around the outer aperture of charge input socket and only visible in dim light.

living & co.

AFTER SALES SUPPORT
☎ 0800 422 274

5
Operation Description

Lighting Control (total three lighting)



* Each time you touch the lampshade to switch to the next mode, cycle control.

CARE AND MAINTENANCE

1. Switch off the lamp and ensure the charge cable is disconnected before cleaning.
2. Clean the lamp with a soft, dry cloth. Do not use any form of abrasive cleaner or solvents to clean it. Never immerse in water or any other liquid.
3. Store the Lamp in a clean, dry, location out of direct sunlight. Do not expose it to temperatures over 35°C or under -15°C.
Caution: Never use a damaged product (e.g., worn cable, cracked casing).

living & co.

AFTER SALES SUPPORT
☎ 0800 422 274