

2024-12-25

130.00 mm

190.00 mm

living & co.

CONVECTOR HEATER

2000W



**INSTRUCTION MANUAL
LCH2000B**

AFTER SALES SUPPORT

☎ (NZ) 0800 422 274

Contents

- 03 SAFETY INSTRUCTIONS
- 05 ASSEMBLY AND OPERATING INSTRUCTIONS
- 06 MAINTENANCE
- 07 RESPONSIBLE DISPOSAL

SAFETY INSTRUCTIONS

IMPORTANT: Read these instructions fully before using the heater. Retain these instructions for future reference.

1. This appliance is not intended for use by persons (including children) with reduced physical, sensory or mental capabilities, or lack of experience and knowledge, unless they have been given supervision or instruction concerning use of the appliance by a person responsible for their safety.
2. Children should be supervised to ensure that they do not play with the appliance.
3. The product is for household use only.
4. Connect the appliance to single phase AC supply of the voltage specified on the rating plate.
5. Warning: In order to avoid overheating, do not cover the heater.
6. Never leave the heater unattended while it is in use. Always turn the product to the OFF position and unplug it from the electrical outlet when not in use.
7. Extreme caution is necessary when any heater is used by or near children, invalids or elderly person and whenever the heater is left operating and unattended.
8. The heater must not be located immediately below an electrical socket-outlet.
9. Do not run cord under carpeting and do not cover cord with throw rugs, runners or the like. Arrange cord away from traffic areas and where it will not be tripped over.
10. Do not operate the heater with a damaged cord or plug, or after the heater malfunctions, has been dropped, or damaged in any manner.
11. If the supply cord is damaged, it must be replaced by the manufacturer or its service agent or a similarly qualified person to avoid a hazard.
12. Avoid the use of an extension cord as this may overheat and cause a risk of fire.
13. Use the heater in a well-ventilated area. Do not insert or allow objects to enter any ventilation or exhaust opening. To prevent a possible fire, do not block air intakes or exhaust openings in any manner. Do not use on soft surfaces, like a bed, where openings may become blocked. Use the heater on flat, dry surfaces only.

SAFETY INSTRUCTIONS

14. Do not place this heater near flammable materials, surfaces or substances, as there may be a risk of fire. Keep the above flammable materials, surfaces or substances at least 1m from the front of the product and keep them away from the sides and rear.
15. Do not use the heater in any areas where petrol, paint or other flammable liquids are stored e.g. garages or workshops, as there are hot, arcing, or sparking parts inside heater.
16. Don't use this heater in the immediate surroundings of a bath, a shower or a swimming pool. Never locate the heater where it may fall into bathtub or other water container.
17. This heater is hot when in use. To avoid burns and personal injury, do not let bare skin touch hot surfaces. If provided, use handles when moving the product.
18. Be sure that no other appliances are in use on the same electrical circuit as your product as an overload can occur.
19. The cord shouldn't be placed near by the hot surfaces of the appliance.
20. NOTE: It is normal for new heaters or heaters that have not been used for a long period of time, to smell or have some noise when first turned on. This will disappear when the heater has been on a short while.
21. Never operate the appliance with wet hands
22. For additional safety, it is recommended that this heater is always used on an outlet fitted with a residual current device (RCD) with a rated operating residual current not exceeding 30mA

ASSEMBLY AND OPERATING INSTRUCTIONS

ASSEMBLY OF THE HEATER

Before using the heater, the feet (supplied separately in the carton), must be fitted to the unit. These are to be attached to the base of the heater using the 4 self-tapping screws provided, taking care to ensure that they are located correctly in the bottom ends of the heater side moldings

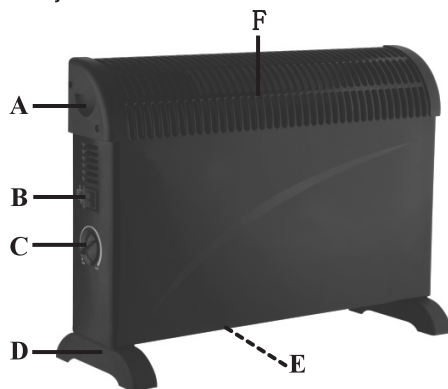
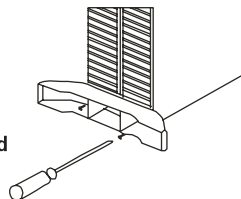

- A. Handle
- B. Power selector
- C. Thermostat knob
- D. Feet
- E. Air inlet grid
- F. Air outlet grid

OPERATION OF THE HEATER

NOTE: It is normal when heaters are turned on for the first time, or when they are turned on after having not been used for a long period of time, that the heaters may emit some smell and fumes. This will disappear when the heater has been on a short while.

Choose a suitable location for the heater, taking into account the safety instructions above.

Insert the plug of the heater into a suitable socket.

Turn the thermostat knob fully in a clockwise direction to the maximum setting.

Turn on the heating elements by means of the rocker switches on the side panel. When the heating elements are on the switches will illuminate. For maximum heat output both switches should be on.

When the desired room temperature has been reached, the thermostat knob should be turned slowly anti-clockwise until the thermostat is heard to click off and the lights on the element switches are seen to go out. After this the heater will keep the air temperature in the room at the set temperature by switching on and off automatically.

MAINTENANCE**CLEANING THE HEATER**

Always unplug the heater from the wall socket and allow to cool down before cleaning.

WARNING:

Do not immerse the heater in water.

Do not use any cleaning chemicals such as detergents and abrasives.

Do not allow the interior to get wet as this could create a hazard.

1. Clean the outside of the heater by wiping with a damp cloth and buffing with a dry cloth.
2. To store the heater, wrap the cord around the cable bobbin and store in a cool dry place.
3. In case of malfunction, do not try to repair the heater yourself. This may result in a fire hazard or electric shock.

SPECIFICATION

220 - 240Vac 50Hz

1800-2000 Watts

Responsible Disposal

At the end of its working life, do not throw this product out with your household rubbish. Electrical and electronic products contain substances that can have a detrimental effect on the environment and human health if disposed of inappropriately. Observe any local regulations regarding the disposal of electrical consumer goods and dispose of it appropriately for recycling. Contact your local authorities for advice on recycling facilities in your area.

Please keep the original packaging carton and materials in a safe place.

It will help to prevent any damage if the product needs to be transported in the future. In the event it is to be disposed of, please recycle all packaging material where possible.



living & co.

Warranty

We pride ourselves on producing a range of quality home appliances that are both packed with features and completely reliable. We are so confident in our products, we back them up with a 2 year warranty. Now you too can relax knowing that you are covered.

Customer Helpline NZ: 0800 422 274
This Product is covered by 2 year warranty when accompanied by proof of purchase.

living & co.

AFTER SALES SUPPORT
☎ NZ 0800 422 274