

Kensington.

Bladeless Tower Fan

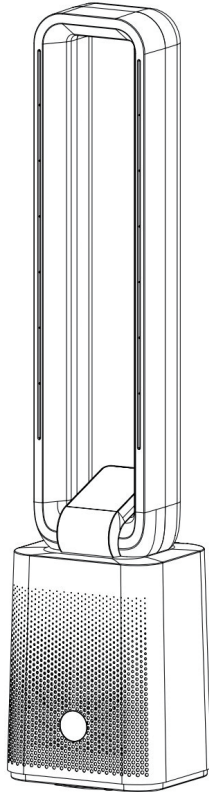

Instruction Manual

TF-2009YD 50W

AFTER SALES SUPPORT

☎ NZ 0800 422 274

Contents

	Page
Important Safety Instructions / Getting Started	3-5
Product Overview	6
Operating Instructions	6-7
Cleaning and maintenance	7-8
Remote Control Battery Replacement	9
Warranty	10

Important Safety Instructions

READ CAREFULLY AND KEEP FOR FUTURE REFERENCE

Read this manual thoroughly before first use, even if you are familiar with this type of product. The safety precautions enclosed herein reduce the risk of fire, electric shock and injury when correctly adhered to. Make sure you understand all instructions and warnings. **Keep the manual in a safe place for future reference**, along with any warranty information, your purchase receipt and the original packaging carton. If you sell or transfer ownership of this product, pass on these instructions to the new owner. **Always follow basic safety precautions and accident prevention measures when using an electrical appliance, including the following:**

Electrical safety and cord handling

- **Voltage:** Make sure your outlet voltage and circuit frequency correspond to the voltage stated on the rating label. If this is not the case, do not use the fan.
- **Water:** To protect against fire and electric shock, do not immerse the cord, plug or the fan itself in water or other liquids, or expose the electrical connections to water. Ensure your hands are dry before handling the plug or switching on the appliance. Do not use the fan outdoors or on wet surfaces. Protect it from liquid spills.
- **Damage:** Check the power cord regularly for visible damage. If the cord is damaged, it must be replaced by the manufacturer, its authorised service centres or appropriately qualified personnel in order to avoid any hazards. **WARNING!** Do not pick up or operate the appliance if the power supply cord, plug or housing is damaged, or after it malfunctions or has been dropped or damaged in any manner.
- **Protect the power cord:**
 - * Do not operate the fan with the cord coiled up; always fully unwind.
 - * Do not twist or kink the cord or let it touch heated surfaces.
 - * Do not put any stress on the cord where it connects to the product.
 - * Never carry the fan by the cord.
 - * Arrange the cord away from any traffic area so no one will trip over it.
 - * Do not run the cord under carpeting or cover it with rugs or runners.
- **Connection:** To insert the plug, grasp it firmly and guide it into outlet.
- **Disconnection:** Switch off and unplug the fan from the power outlet when it is not in use, during lightning storms and before cleaning, servicing, moving or storing the fan. Grasp the plug and remove it from the outlet, do not pull the cord when disconnecting.

Important Safety Instructions (Cont.)

- **RCD:** Unless your home is already fitted with a residual current device (safety switch), we recommend installing an RCD with a rated residual operating current not exceeding 30mA to provide additional safety protection when using electrical appliances. See your electrician for professional advice.

Usage conditions and restrictions

- **Domestic use only:** This appliance is intended for indoor household use only. It is not suitable for commercial, industrial, trade or outdoor use. Do not use it for anything other than its intended purpose, and only use it as described in this manual. Any other use may cause fire, electric shock or injury.
- **Attachments:** The use of accessories not intended for use with this fan may cause injuries to the user or damage to the appliance.
- **Liability:** We assume no liability for any damages or personal injury caused by misuse of the product and/or failure to follow these instructions.
- **Usage restriction:** This fan is not intended for use by children and persons with reduced physical, sensory or mental capabilities, or lack of experience and knowledge, unless they have been given supervision or instruction concerning use of the appliance by a person responsible for their safety.
- **Children:** This fan is not a toy. Supervise children to ensure they do not play with it. Close supervision is necessary when any appliance is used by or near children.
- **WARNING! Do not leave unattended during use!** Always switch it off and unplug when not in use, if left unattended and before cleaning and storing.
- **Location:** Place the fan on a dry, flat, stable surface to avoid overturning.
- **Keep clear:** Ensure nothing is blocking the airflow outlet, air intake grilles or ventilation openings.
- **WARNING! DO NOT use the fan in the following areas:**
 - * Near an open flame, a hot burner, oven or other source of high heat.
 - * On a soft surface (such as carpet) or where it may tip over during use.
 - * Outdoors or in areas of high humidity.
 - * In a bathroom, laundry area, near a sink, washer, pool or any source of water.
 - * Near curtains or in tight corners, to enjoy maximum airflow.
 - * In areas where paint, petrol, etc. is stored and there is a risk of explosion or fire from flammable gases, or in areas where substances are being sprayed.
- **CAUTION! Personal safety:** Avoid contact with moving parts. Never insert fingers, pencils or any other objects through the grilles when the fan is running, as this may cause electric shock and/or a fire hazard. Keep hair and loose clothing well away from the fan when it is in use.

Getting Started

Before first use

- **Unpacking:** This product has been packaged to protect it against transportation damage. Unpack the appliance and keep the original packaging carton and materials in a safe place. It will help prevent any damage if the product needs to be transported in the future, and you can use it to store the appliance when it is not in use. In the event it is to be disposed of, please recycle all packaging materials where possible.
- **Safe packaging disposal:** Plastic wrapping can be a suffocation hazard for babies and young children, so ensure all packaging materials are out of their reach and disposed of safely.
- **Inspection:** Unwind the cord to its full length and inspect it for damage. Do not use the appliance if the appliance or its cord have been damaged or are not working properly. In case of damage, contact our after sales support centre for advice on examination, repair or return of the damaged product.

Product Overview

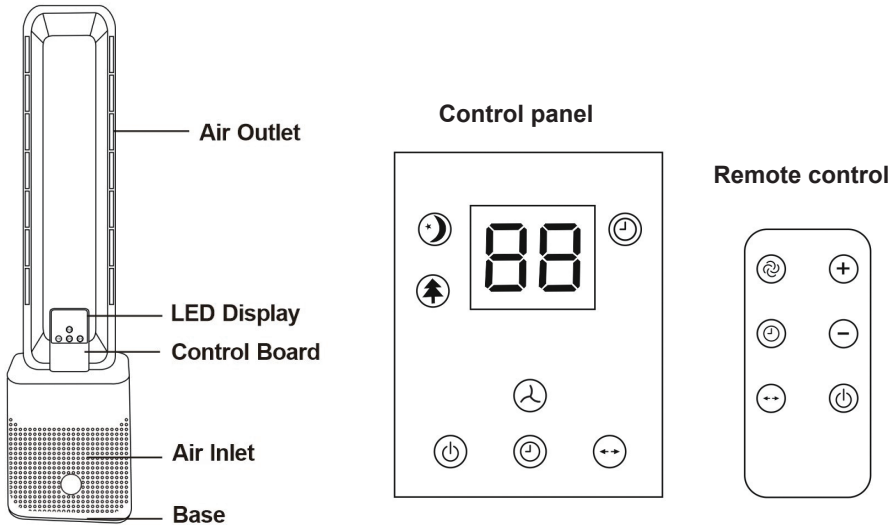

Operating Instructions

Initial setup

- Decide on a location for the fan, convenient to a supply socket. It is designed for floor use. Place the fan on a dry, level surface where it will not overturn during use. If moving the fan to a different location, switch off and unplug it from the mains.
- Insert the power plug into an appropriate electrical outlet and switch on power to the outlet.

Switching the fan on/off

- Press the ON/OFF button on the control panel (or remote control) once to switch the fan on, this will default to the low speed setting and the LED display will show the current speed setting.
- Note: After approximately 3 minutes of operation the LED display screen will switch off automatically.

SPEED selection:

Push the speed button to adjust from 1-12 fan speeds, subsequent presses cycle through the speeds which are displayed on the LED panel.

Push "+" "-" on the remote control to step through the 1-12 speed levels.

OSCILLATION / SWING button :

Push the oscillate button on the control panel or remote control which will allow the fan to pivot side to side gently varying the outlet air direction.

For stationary operation, press the Oscillate button when the air is blowing in the desired direction.

Note: Do not turn the body directly by hand and change the air supply direction forcibly, otherwise it will damage the mechanism.

TIMER button:

To activate the timer function, press the "TIMER" button, each subsequent press will step through from 0 - 15 (hours). When the desired time is set, the clock symbol will be activated on the LCD screen. At the end of the preset period, the fan will automatically switch off.

MODE button (Only available on the remote control):

- There are three wind functions, Continuous (normal) / Natural and Sleep. One press of the mode button activates Natural Wind function, this is indicated by the tree symbol. A second press activates the Sleep Wind Function, indicated by the moon/star symbol. A third press activates the continuous (normal) wind function. Subsequent presses of the button will cycle through the options.
- Natural Wind:
The fan operates with irregular and varying speeds.
- Sleep Wind:
On high speed, the first half hour operates as high Natural wind, the second half hour operates as medium speed Natural wind, after which time it operates as low speed Natural wind.
On Mid speed, the first half hour operates as mid speed Natural Wind, after that it continues to operate as low speed Natural wind.
On Low speed, it operates as low speed Natural wind continuously.

Cleaning and maintenance

- **Dusting:** Clean your fan periodically by lightly running a vacuum cleaner nozzle (soft brush) over the front outlets and rear grilles to remove any dust or dirt that may have accumulated inside or on the unit. Alternatively, use a soft, dry cloth for dusting.
- **Storage:** In the off season, store the clean and dry fan in a safe, dry location, protected from dust and located so it is not in direct sunlight.
- **Service/repair:** The appliance requires no maintenance and contains no user-serviceable parts.

Air inlet filter

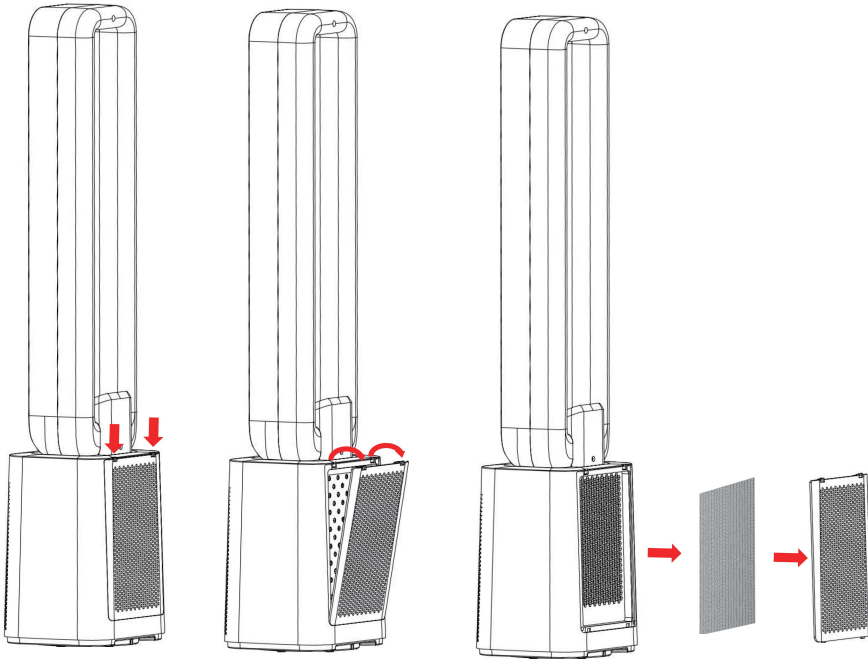

- The air inlet foam filter should be cleaned periodically, dependent on use. For heavy use, check monthly.
- Press the latching clips as shown to release the inlet filter grille.
- The foam filter can be removed and if heavy dust deposits are present, rinse the filter in lukewarm water to remove dust.
- Shake off excess water and then place the filter on a paper towel to drain.
- Allow the filter to naturally (fully) dry before reinserting. Do not use artificial means to speed up the drying process (such as hairdryer or oven).
- Once refitted, fit the detachable grille cover, pushing to align and click back into place.

Remote Control Battery Replacement

If the battery in the remote control is flat, replace with a new 3V CR2025 size button cell type as follows:

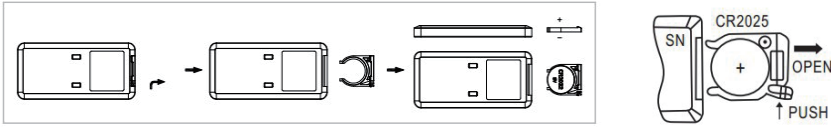

- Remove the security screw.
- Unlatch the battery holder by pressing the retaining clip inwards and apply a pull force.
- Replace the battery, carefully noting the polarity orientation ("+" on visible side).
- Slide the carriage holder back into the remote ensuring it locks in position.
- Refit the security screw, do not over tighten.
- Dispose of the old battery appropriately and keep away from small children.

Battery precautions



WARNING! Keep batteries out of reach of children. Swallowing may lead to serious injury or death in as little as 2 hours due to internal burns. If swallowed, go straight to a hospital

Responsible disposal

- At the end of its working life, make the appliance unserviceable by unplugging it from the power outlet and cutting the power cord.
- Do not throw this appliance out with your household rubbish. Electrical and electronic products contain substances which can have a detrimental effect on the environment and human health if disposed of inappropriately. Observe any local regulations regarding the disposal of electrical consumer goods and dispose of it appropriately for recycling. Contact your local council for advice on recycling facilities in your area.

Compliance

This appliance has been fully tested and meets all requirements as set out by standard AS/NZS 60335.2.80.



E2198

The RCM Mark (Regulatory Compliance Mark) indicates that the product complies with the relevant EMC requirements as well as corresponding government requirements for the safety of electrical devices.



Kensington.

Warranty

We pride ourselves on producing a range of quality home appliances that are both packed with features and completely reliable. We are confident in our products, we back them up with a 3 year warranty. Now you too can relax knowing that you are covered.

Customer Helpline NZ: 0800 422 274

This product is covered by 3 years warranty when accompanied by proof of purchase.

IM Version 1.0 June 2025