

poppi

ULTRASONIC JEWELLERY CLEANER

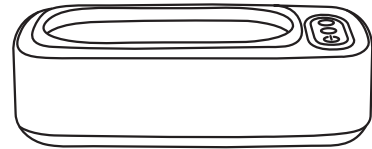

Instruction Manual Model: CASE20023

Before operating this ultrasonic jewellery cleaner, please read these instructions completely and save this manual for future use.

AFTER SALES SUPPORT
☎ NZ 0800 422 274



Attention

In order to prevent harm to the users and other personnel; To avoid property loss, please be sure to abide by the following warnings:

- This device is not a toy, keep out of reach of children. It can lead to burns, electric shock and injuries.
- This device is not intended for use by persons (including children) with reduced physical, sensory or mental capabilities, or lack of experience and knowledge, unless they have been given supervision or instruction concerning the use of the device by a person responsible for their safety.
- People with pacemakers implanted in their bodies should not use this product, as it may cause discomfort.
- Please add water to the cleaning tank before use. ...Operation without water can cause permanent damage.
- Do not put flammable liquids in the container, this could result in fire.
- Do not immerse the main body in water or overflow the tank. This could result in water entering the interior, which in turn may lead to electric shock, fire and malfunction.
- To prevent the risk of accidental misplacement into water, do not use next to a sink bench / basin or bath.
- Do not disassemble, repair or modify this product. ... It can lead to electric shock or injury.
- Do not unplug or insert the power adapter of the main unit into the socket with wet hands. It can lead to fire, electric shock and malfunction.
- When not in use, please unplug the power adapter of the main unit from the power socket.
- Avoid directly looking at the LED light for extended periods.
- Do not add disinfectants, sterilizers or acidic solvents to the cleaning water. It will lead to the deterioration of the resin part and the damage of the stainless steel part. Only use dedicated ultrasonic cleaning solutions, water based detergents such as dish soap or washing up liquid.
- Do not clean jewellery items with low surface hardness such as pearls (MOHS hardness below 8). Soft or delicate stones or materials may be damaged by way of cracking or discolouration.
- To avoid the potential risk of damage, it is recommended to avoid cleaning gemstones such as emeralds or pearls.
- Do not clean rings/necklaces with gemstones/diamonds for long periods (no greater than 2 x 5 min cycles). Extended periods of cleaning may cause gemstones/diamonds to fall out or loosen from clasps.
- The supplier takes no responsibility for damage caused to personal items from not correctly following the recommendations and warnings detailed in this manual.
- Only use the device in conjunction with the power adapter provided, with an output of 12V DC, 2A.

AFTER SALES SUPPORT
☎ NZ 0800 422 274

poppi 1



Method of operation

After checking the device, plug in the power adapter, open the upper cover, and pour clean water into the stainless steel inner tank. Fill no greater than the max line (300ml). Ensure the items to be cleaned are fully immersed in the water. Refit the upper cover.
Press the power button to turn on the device, the indicator light will flash. Then press the button again to select the two ultrasonic modes: 3 minutes or 5 minutes. When the indicator light stops flashing, the device commences operation. Press the power button again and the machine will shut down.

Three operating modes:

3 minutes or 5 minutes ultrasonic and Light
Light only.

Note: When using the 3-minute and 5-minute modes, the LED Light function will also operate simultaneously (the white indicator light beside the water tank is on). Alternatively, this can be activated on its own (no ultrasonic function).

Ordinary cleaning

Just fill it with clean water. The items to be cleaned should be completely submerged in water, but the water level should not exceed the "max" of the highest water level line.

Deep cleaning

When items have not been cleaned for a long time or the dirt is stubborn, for improved results, add about 3 to 5 drops of ultrasonic cleaning solution to the water. This can accelerate the decomposition of the dirt and enhance the cleaning effect of ultrasonic waves by about 20%. (Note: After using the enhanced cleaning method here, the cleaning effect can also be improved by repeatedly cleaning or extending the cleaning time.) Alternatively, try a few drops of water based dish washing liquid.

Operation illustration

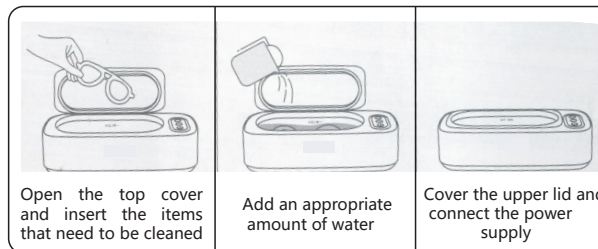

2 poppi

AFTER SALES SUPPORT
☎ NZ 0800 422 274

96mm

To avoid harm caused by misuse, carefully read the user manual before using this product and use it strictly in accordance with the instructions. After continuous use without interruption, if the indicator light flashes continuously for three times and then stops, it indicates that the overheat protection has been triggered. Please wait for five minutes before using it again.

Component description

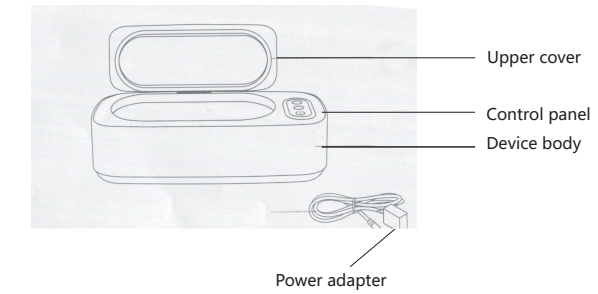

Note: The product images are indicative only and may vary from the actual product.

AFTER SALES SUPPORT
☎ NZ 0800 422 274

poppi 3

141mm

? Analysis of common problems

Fault phenomenon	Cause analysis	Troubleshooting
It cannot be turned on normally	The working indicator light is not on	Reinsert all the plugs
Cleaning is inadequate	Heavily soiled items have not been recently cleaned	Extend operating cycles or add ultrasonic cleaner
Vibration noise	This is normal and indicates the ultrasonic function is working	No action likely required but check the water level
Water spills during use	Max fill level has not been observed	Ensure excessive water not added.



Maintenance and repair

- When cleaning and maintaining, please unplug in the power adapter first.
- Use a measuring cup to pour water into the cleaning tank until it reaches half the maximum water level mark. Clean with a soft sponge. When the stains are severe, add 1-2 drops of neutral detergent. After cleaning, rinse thoroughly with clean water.
- Wipe the surface of the machine with a damp cloth, clean it thoroughly, and then dry the moisture with a dry cloth.
- Be careful not to let water seep into the switch and power connection points during cleaning.

4 poppi

AFTER SALES SUPPORT
☎ NZ 0800 422 274

Warnings:

- Pay attention that there should be no moisture on the control switch. If there is moisture, it must be wiped clean; otherwise, the device may not switch on reliably.
- When cleaning glasses, place the lenses upwards and avoid direct contact with the stainless steel tank.
- It is strictly prohibited to put coated or colour-coated glasses in for cleaning.
- Do not directly use the tap to add water, as it may cause electric shock or malfunction.
- The "buzzing" sound during the cleaning process is an ultrasonic vibration sound and is a normal phenomenon.
- When the machine is used continuously for multiple times, the indicator light will flash continuously and stop working to prevent overheating and malfunction. It can be used again after 5 minutes.
- Operating without water will damage the machine.

Product application scope

Type	Specific examples
Eyewear category	Glasses
Office supplies category	Rulers, scissors, pens and other pen tips
Daily necessities category	Toothbrushes, razor blades, combs, etc
Jewelry and ornaments category	Rings, necklaces, earrings, etc
Tableware and utensils category	Metal tableware, ceramic tableware, dentures, etc

Type	Specific examples
Wood products	Sunglasses, coated glasses, turtle case frames, pearls, earthen stones, ivory, opals, emeralds, stones, coral, jade, contact lenses, lacquerware, water-resistant watches, etc.
Gemstones with relatively soft surface hardness	
Products with inferior coating and finishing processing	
Adhesive and pasted gemstone types	
Items with scratches and cracks	

AFTER SALES SUPPORT
☎ NZ 0800 422 274

poppi 5

Reminder:

- It may not be possible to completely remove tartar, dental plaque, wax yellow, black spots, smoking plaque and other substances remaining in the dentures
- It may not be possible to clean the fixed items in the dentures
- The discoloration and rusting of metals cannot be completely removed
- When cleaning bonded gemstone/diamond necklaces/index fingers, it may cause the gemstones/diamonds to fall off.
- When cleaning a metal watch strap, please remove it from the main body of the watch before cleaning. Only use cleaning solution or water to clean it. Do not put the watch (including water-resistant ones) in for cleaning, as water may enter the watch and the ultrasonic vibration may cause damage to the internal parts of the watch main body.

Cleaning times

Washable items	Cleaning time
Glasses Rulers, scissors, pens Toothbrushes, razor blades, combs, etc	3 minutes
Rings, necklaces, earrings, etc Metal tableware, ceramic tableware, dentures, etc	5 minutes

Excessive cleaning can lead to item damage and part detachment.



Environmental

Do not dispose of this device with the domestic waste. Contact your local council for details on local e-waste collection points to contribute to environmental protection.

6 poppi

AFTER SALES SUPPORT
☎ NZ 0800 422 274



Read the manual.
It will help you get the best out of your product.
Still have questions?
Call After Sales Support
0800 422 274

poppi

Warranty

We pride ourselves on producing a range of quality home appliances that are both packed with features, and completely reliable. We are so confident in our products, we back them up with a one year warranty when accompanied by proof of purchase.
Now you too can relax knowing that you are covered.
Customer Helpline NZ: 0800 422 274
IM Version 1.0 – April, 2025

AFTER SALES SUPPORT
☎ NZ 0800 422 274

poppi 7