

TRIPLE ROTARY SHAVER



INSTRUCTION MANUAL Rs8998

AFTER SALES SUPPORT
0800 422 274

1封面

CONTENTS

SAFETY INSTRUCTIONS	2-3
PRODUCT OVERVIEW	4
PART NAMES	4-5
OPERATION	5-6
QUICK STORAGE	7
CLEANING AND LONG-TERM STORAGE	7
FAULT FINDING	7
PRODUCT SPECIFICATION	8
ENVIRONMENTAL PROTECTION	8
WARRANTY	9

AFTER SALES SUPPORT
0800 422 274

living & co. 1

3

SAFETY INSTRUCTIONS

When using an electrical appliance, basic precautions should always be observed to reduce the risk of electric shock, fire and injury to persons or property, including the following:

- Never charge the appliance at a temperature of 0°C or below, or above 40°C.
- Please observe the Safety instructions. Failure to observe it may result in death, serious injury, electric shock, fire or short circuit.
- Disconnect the USB cable from the outlet when cleaning the clipper.
- Please do not insert and remove the charge cable with wet hands, do not allow the connections to get wet.
- Please do not wipe the clipper or cable with thinner, benzene or alcohol.
- This appliance is not intended for use by persons (including children) with reduced physical, sensory or mental capabilities, or lack of experience and knowledge, unless they have been given supervision or instruction concerning use of the appliance by a person responsible for their safety.
- Children should be supervised to ensure that they do not play with the appliance.
- Suitable for cleaning under an open water tap.
- **WARNING:** Detach the hand-held part from the supply cord before cleaning it in water.
- After each use, please fit the protective cover to the cutting head to prevent damage.
- To prevent the risk of personal injury, **NEVER** use the appliance if the cutting parts are damaged or broken.

2 living & co.

AFTER SALES SUPPORT
0800 422 274

4

SAFETY INSTRUCTIONS CONTINUED

- To prevent the risk of personal injury, NEVER use the appliance if the cutting parts are damaged or broken.
- Keep the appliance out of reach from children.
- Do not use the shaver if the USB cable is worn, or if the connector does not fit snugly in the outlet.
- Do not use any charge lead other than the one specifically designed for this model.
- Do not store the shaver near a place exposed to direct sunlight or near a heater other source of heat.
- The shaver may become warm during operation and/or charging. This is normal.
- For hygiene reasons, do not share this appliance with other people, product is intended for personal use only.
- No liability can be accepted for any damage caused by non-compliance with these instructions or any other improper use or mishandling.
- Ensure any used batteries are disposed of at an officially assigned location.
- If the shaver is not working correctly, have it inspected by an authorized service center.

AFTER SALES SUPPORT
0800 422 274

living & co. 3

5

PRODUCT OVERVIEW

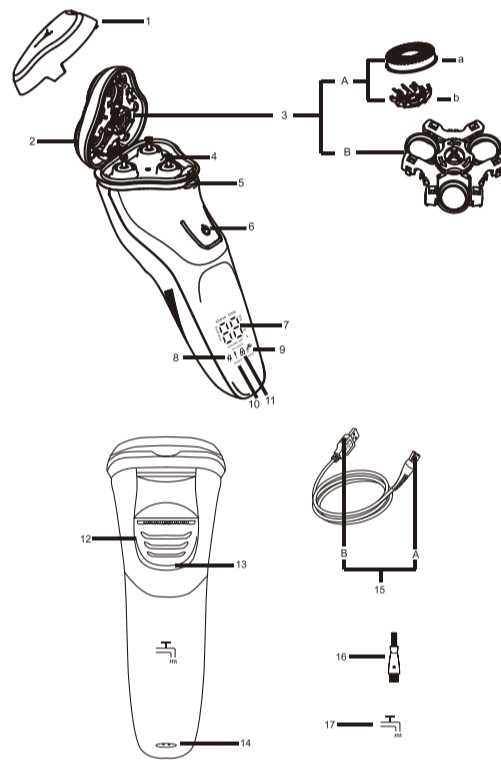

PART NAMES

- Protective cap
- Foil frame
- Shaving head floating system
 - A (a-Shaving cap b-Shaving head)
 - B Floating frame

4 living & co.

AFTER SALES SUPPORT
0800 422 274

6

- Hair chamber
- Release knob of shaving head
- ON/OFF button
- Remaining operating time display
- Charge display
- 'Clean Shaving Head' Indicator light. Light will illuminate after 30 minutes use. Use cleaning brush to clear shaving head
- Locked reminder
- Travel lock (hold button for 3 seconds to activate / deactivate)
- Pop-up Trimmer
- Trimmer handle
- Charging interface
- USB charging cable
 - A: Charging port
 - B: 5V USB connector
- Cleaning brush
- Waterproof symbol

OPERATION

Using your shaver

- Remove the protective cap.
- Depress the on/off button to switch the shaver on.
- Move the shaver smoothly over your skin and against the growing direction of beard. Make circular movements.
- After use, if you are traveling, press on/off button for 3 seconds to activate travel lock. Travel lock function can prevent the consumption of electricity in travel. Press on/off button for 3 seconds to unlock for next use.
- Put the protective cap on the shaver every time you have used to prevent damage of shaving cap. Slide the trimmer knob down to open the trimmer at a right angle (90 degrees) to your skin and move it downward to trim sideburns.

AFTER SALES SUPPORT
0800 422 274

living & co. 5

7

- Trimming: Turn shaver ON; Push up spring-release trimmer switch. The trimmer can be activated while the shaver is running; Hold the trimmer and make downward strokes with gentle pressure; Close trimmer by pressing trimmer down, Turn shaver off.

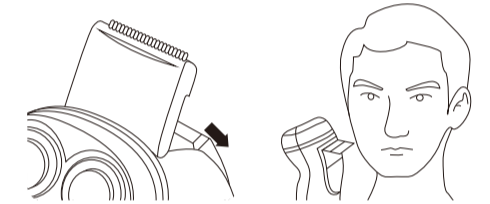

When your shaver is used for 30 minutes, the clean indicator light will operate. For hygiene and product longevity, it is recommended to clean the shave head at this time.

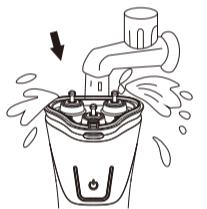

6 living & co.

AFTER SALES SUPPORT
0800 422 274

8

QUICK STORAGE

- Switch the ON/OFF switch to the "OFF" position.
- Unplug the power cord.

- Keep it in a safe and dry place, free of dust.

CLEANING AND LONG-TERM STORAGE

Note When your shaver is used for 30 minutes, the clean indicator light will illuminate (refer item 10. Page 4). For hygiene and product longevity, it is recommended to clean the shave head at this time. Regular cleaning will keep your shaver in good condition and prevent odors or bacteria from developing.

- Switch off the shaver.
- Push the foil release button and remove the foil frame counter clockwise, noting the outer foil release button. Remove the assembly outer then the inner cutter.
- Clean the guard, foil frame, hair chamber and the shaver body with the long side of brush. Clean the inner cutter with the short side of brush.
- Reassemble the shaver parts in the reverse order.

FAULT FINDING

Problem	Cause	Solution
The shaver does not work	The power is off	Please charge the shaver
The noise is too high	The shaver head is dislocated/dirty	Clean the shaver head

AFTER SALES SUPPORT
0800 422 274

living & co. 7

9

PRODUCT SPECIFICATION

Model No	Rs8998
Motor Voltage	3.6V
Rated Power	5W
Recharging Time	60 minutes
Using Time	60 minutes

This product is intended for household use only.

ENVIRONMENTAL PROTECTION



Responsible Disposal

At the end of its working life, do not throw this product out with your household rubbish. Electrical and electronic products contain substances that can have a detrimental effect on the environment and human health if disposed of inappropriately. Observe any local regulations regarding the disposal of electrical consumer goods and dispose of it appropriately for recycling. Contact your local authorities for advice on recycling facilities in your area. Please keep the original packaging carton and materials in a safe place. It will help to prevent any damage if the product needs to be transported in the future. In the event it is to be disposed of, please recycle all packaging material where possible.

8 living & co.

AFTER SALES SUPPORT
0800 422 274

10



Read the manual.
It will help you get the best out of your product.

STOP

BEFORE RETURNING TO STORE

Still have questions?
Call After Sales Support
0800 422 274

Warranty

We pride ourselves on producing a range of quality home appliances that are both packed with features, and completely reliable. We are so confident in our products, we pack them up with a 1 year warranty.

Now you too can relax knowing that you are covered.

Customer Helpline NZ: 0800 422 274

This product is covered by a 1 year warranty when

Accompanied by proof of purchase.

IM Version 1.0 – June, 2025

AFTER SALES SUPPORT
0800 422 274

living & co. 9

11

12封底
空白页