

Mens Head Shaver



INSTRUCTION MANUAL

Rs2024

AFTER SALES SUPPORT
0800 422 274

CONTENTS

| | |
|-----------------------------------|-----|
| PRO IMPORTANT SAFETY INSTRUCTIONS | 2-3 |
| PRODUCT OVERVIEW | 4 |
| CHARGING | 5 |
| HOW TO USE | 6-7 |
| CLEANING | 8 |
| REPLACE SHAVING HEAD | 9 |

AFTER SALES SUPPORT
0800 422 274

living & co. 1

IMPORTANT SAFETY INSTRUCTIONS

- Please read the instruction manual carefully before using the product.
- This device is waterproof, which means it can be washed under the water. However we recommend that you do not leave it in water or damp places for extended amounts of time.
- **WARNING:** Separate the handheld part from the power cord before cleaning the handheld part in water.
- This product uses a USB charging cable.
- You can use the 5V adapter mobile phone charger, or a USB interface of cars, computers and others for charging.
- If the charging cable is damaged, replace it with anew one to avoid danger.
- Keep the product between 5°C to 35°C when charging. Please don't put the device in places where sunlight shines directly on it or excessively hot places while charging.
- Make sure the charge and charging cable are dry. Do not plug or unplug with wet hands to prevent electric shock.
- Please check if the foil is damaged or deformed before use to avoid damage to your skin.
- Do not use salt water, hot water above 60°C thinners, gasoline, alcohol or other chemicals to clean the head shaver.
- it's necessary to ensure to cover the head shaver with the protective cover when you travel to protect its foil.
- During the use and charging process, the head shaver may be slightly heated. This is normal and please feel free to use it.
- Please do not charge the head shaver too long.
- Do not store the head shaver in direct sunlight or near other sources of heat.
- This appliance is not intended for use by persons (including children) with reduced physical, sensory or mental capabilities, or lack of experience and knowledge, unless they have been given supervision or instruction concerning use of the appliance by a person responsible for their safety.
- Children should be supervised to ensure that they do not play with the appliance

2 living & co.

AFTER SALES SUPPORT
0800 422 274

1装订封面

2空白页

3

4

IMPORTANT SAFETY INSTRUCTIONS

- If the shaver operation is not normal, please send the product to an authorized repair service center.
- To prevent the risk of personal injury, NEVER use the appliance if the cutting parts are damaged or broken.
- Keep the appliance out of reach from children.
- Do not use the shaver if the power cord or the DC adaptor is worn, or if the DC adaptor does not fit snugly in the outlet.
- Do not use any power cord or DC adaptor other than the one specifically designed for this model.
- To prevent electric shock or personal injury, disconnect the power cord from the shaver and turn off the shaver before cleaning.
- For hygiene reasons, do not share this appliance with other people, product is intended for personal use only.
- No liability can be accepted for any damage caused by non-compliance with these instructions or any other improper use or mishandling.
- Ensure any used batteries are disposed of at an officially assigned location.

This appliance is IPX6 and waterproof. You can easily rinse it under tap for cleaning.

WARNING: Do not use this appliance near bathtubs, showers, basins or other vessels containing water. Do Not Immerse in Water.

AFTER SALES SUPPORT
0800 422 274

living & co. 3

5

PRODUCT OVERVIEW

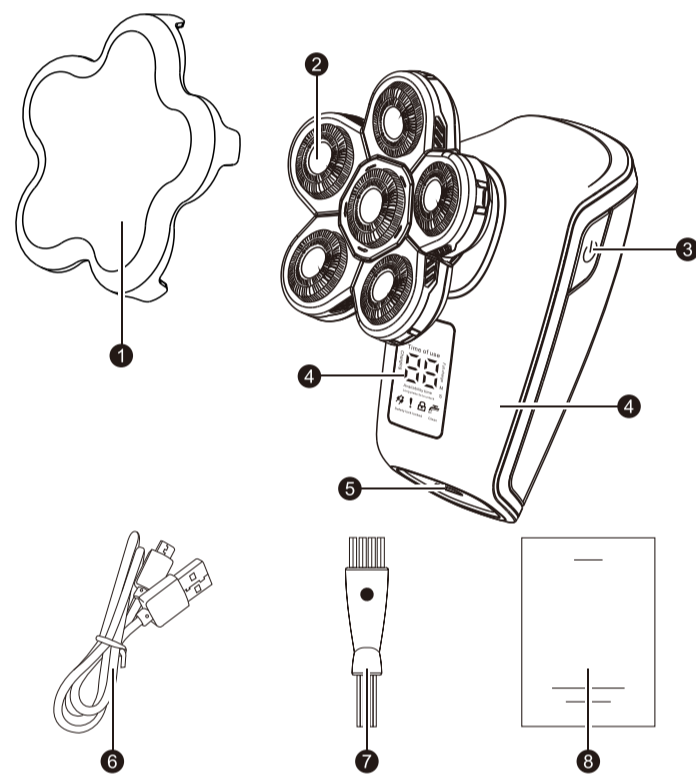

PART NAMES

- 1. Protective Cover
- 2. Blade Mesh
- 3. Switch
- 4. LED
- 5. USB Port
- 6. TYPE-C Cable
- 7. Clean Brush
- 8. User Manual

Availability time
There are 5 minutes left in the usage time. Prompt to charge
Blocked rotation prompt
Long press 3s to lock
After 15 minutes of cumulative use, it will prompt for water washing

4 living & co.

AFTER SALES SUPPORT
0800 422 274

6

CHARGING

- When the display shows "Available time, 05 minutes", the indicator light will flash, indicating that the battery is low-energy and needs charging. (Fig.1)
- Plug the USB charging cable end into the head shaver, then connect the USB cable to the charger and plug it into the power socket (Fig. 2), or plug the other end of the USB cable into a USB port of computers or cars.
- When the power is turned on, the display will light up, with scrolling numbers which will increase as the charging time extends, indicating that it's charging. (Fig.3)
- Full charging takes about 1.5 hour on a continuous basis. After full charging, "FU" will be displayed, indicating the shaver has been fully charged and can be used for about 90 minutes. (Fig. 4)

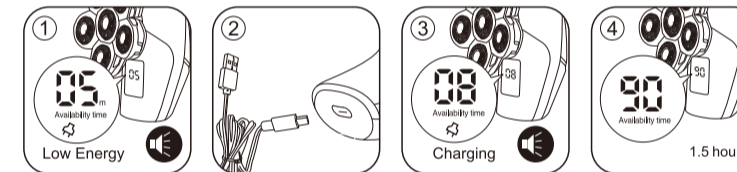

- **WARNING:** The LED display of this product can display remaining energy. A fully charged head shaver can provide a shaving duration up to about 90 minutes. but the actual shaving duration may be less than expected due to differences in shaving habits, cleaning habits and beard types.

The head shaver can be used at the same time it's being charged by means of USB cable connection if it still has remaining energy.

AFTER SALES SUPPORT
0800 422 274

living & co. 5

7

HOW TO USE

- **Shave Head**
- Press the switch button to turn on the head shaver. (Fig. 5)
- Before shaving your head, clean it with warm water and keep your hair dry. For a better effect of use, please use the brush if you need to clean the shaving head during the head shaving process, and wash the shaving head after shaving is completed. (Fig.6)

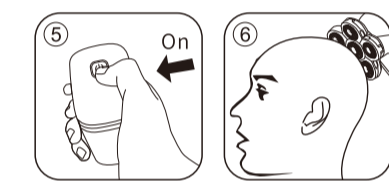

- When shaving completed
Press the switch button again to turn off the head shaver, and then cover it with the protective cover to avoid damages to the foil.

Please do not use any damaged shaving head to avoid injury to your skin.

- **Travel Lock**
- Press and hold the head shaver switch button for 3 seconds, and then the head shaver LED display indicates that the safety lock has been locked. (Fig. 7)
- Repeat the above step to unlock. (Fig. 8)

6 living & co.

AFTER SALES SUPPORT
0800 422 274

8

HOW TO USE

Intelligent Display of Contents

- When the head shaver is overloaded, it will be automatically turned off, and the LED display will indicate stall protection. At this time, it should be cleaned up before use. (Fig.9)
- When the faucet symbol flashes on the LED display, it indicates that the head shaver needs to be cleaned. (Fig. 10)

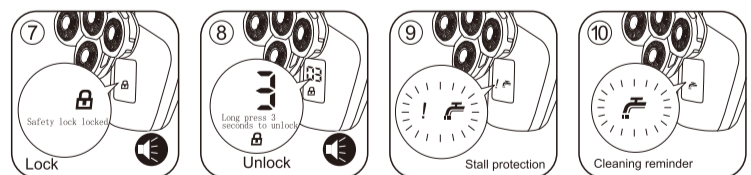

AFTER SALES SUPPORT
0800 422 274

living & co. 7

9

CLEANING

- Before cleaning, be sure to separate the head shaver from the USB charging cable and press the switch to the off state.
- Pinch both sides of each shaving head to lift up and open all shaving heads. (Fig. 11)
- The head shaver can be washed directly under running tap (Fig. 12), but please do not soak it in water for a long time.
- After washing, drain any excessive water, put it horizontally and air-dry it. Do not wipe the shaving head part with tissue or cloth, which may cause damage.
- First air-dry the head shaver, then cover it with the protective cover to prevent damage to the foil and avoid accumulation of dust.
- After the head cutting is dried, First put the middle little head cutting aim at the card slot, then rotate 15 degree in a clockwise direction, Finally close the edge head cutting in turn. (Fig 13)

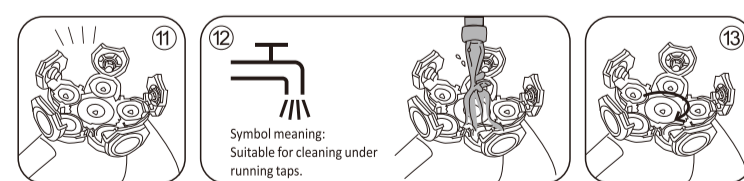

8 living & co.

AFTER SALES SUPPORT
0800 422 274

10

RECYCLING

- Contact your local authorities for advice on recycling facilities in your area. Please keep the original packaging.

RESPONSIBLE DISPOSAL

- At the end of its working life, do not throw this product out with your household rubbish. Electrical and electronic products contain substances that can have a detrimental effect on the environment and human health if disposed of inappropriately. Observe any local regulations regarding the disposal of electrical consumer goods and dispose of it appropriately for carton and materials in a safe place. It will help to prevent any damage if the product needs to be transported in the future. In the event it is to be disposed of, please recycle all packaging material where possible.

Separate the handheld part from the power cord before cleaning the handheld part in water.

AFTER SALES SUPPORT
0800 422 274

living & co. 9

11



Warranty

We pride ourselves on producing a range of quality home appliances that are both packed with features, and completely reliable. We are so confident in our products, we pack them up with a 1 year warranty.

Now you too can relax knowing that you are covered.
Customer Helpline NZ: 0800 422 274

This product is covered by a 1 year warranty when accompanied by proof of purchase.

IM Version 1.0 – May, 2025

AFTER SALES SUPPORT
0800 422 274

living & co. 7

AFTER SALES SUPPORT
0800 422 274

12装订封底