

**living & co.**

**VACUUM CLEANER  
2400W**

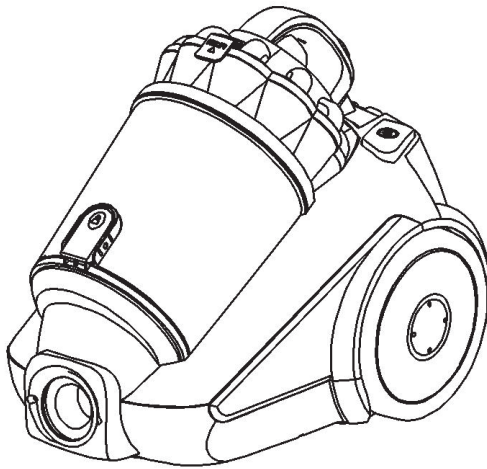

**INSTRUCTION MANUAL  
SL157E**

**PLEASE SAVE THESE INSTRUCTIONS**

Read these instructions carefully before using your Hand Vacuum.

If you follow the instructions, your Vacuum Cleaner will provide you with many years of good service.

<b>Model:</b>	SL157E
<b>Rated Voltage:</b>	AC 220-240V, 50/60Hz
<b>Rated Power:</b>	2400W

## Contents

- 4. IMPORTANT SAFETY INSTRUCTIONS
- 8. GETTING TO KNOW YOUR VACUUM CLEANER
- 9. ASSEMBLING THE VACUUM CLEANER
- 10. INSTRUCTION FOR USE
- 12. MAINTENANCE

## IMPORTANT SAFETY INSTRUCTIONS

1. Read all instructions before using.
2. This appliance is not intended for use by persons (including children) with reduced physical, sensory or mental capabilities, or lack of experience and knowledge, unless they have been given supervision or instruction concerning use of the appliances by a person responsible for their safety.
3. The appliance is not a toy. Children should be supervised to ensure that they do not play with the appliance.
4. This appliance is intended to be used in household and similar applications, Use as described in this instruction
5. Before using the appliance, check that the mains power voltage corresponds to the voltage shown on the rating plate.
6. If the supply cord is damaged, it must be replaced by the manufacturer or its service agent or a similarly qualified person in order to

avoid a hazard.

7. Never leave the appliance unattended when it is switched on.

8. Turn off the switch and unplug the power cord when the appliance is not in use and before maintenance

9. Do not use the appliance on wet surfaces. Do not vacuum liquid and inflammable material. Do not vacuum burning material and ashes, Do not use the appliance to vacuum needles, drawing pins or strings.

10. Do not pull or carry by cord, use cord as a handle, close a door on cord, or pull cord around sharp edges or corners, do not run vacuum cleaner over cord, keep cord away from heated surfaces.

11. Do not remove the plug from the socket by pulling the cable or the appliance itself.

12. Do not store or use the machine close to high temperature places.

13. Do not switch the appliance on if it appears

to be faulty in any way. If abnormal noise, smell, smoke or any other failure or breakage is found during the operation, contact with your service center for repair. Do not repair by yourself.

14. Do not obstruct the air intake or outlet vent.

15. For accessories or repairs, contact your dealer or an authorized Service Center.

16. Never operate the appliance with wet hands.

17. It is recommended to have a residual current device (safety switch) installed by qualified electrician to provide additional safety protection when using all electrical appliances.

Do not remove the plug from by pulling the cable the or appliance itself

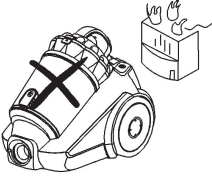

Do not run the appliance over the power cable

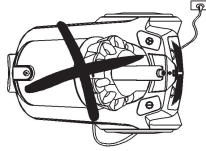

Do not use the appliance to vacuum lighted matches, cigarette ends or hot ash.



Do not use the appliance on wet surfaces.



Do not obstruct the air intake or outlet vent.

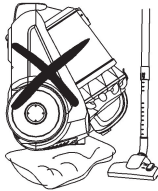

Do not use the appliance to vacuum needles, drawing-pins or string.



## GETTING TO KNOW YOUR VACUUM CLEANER

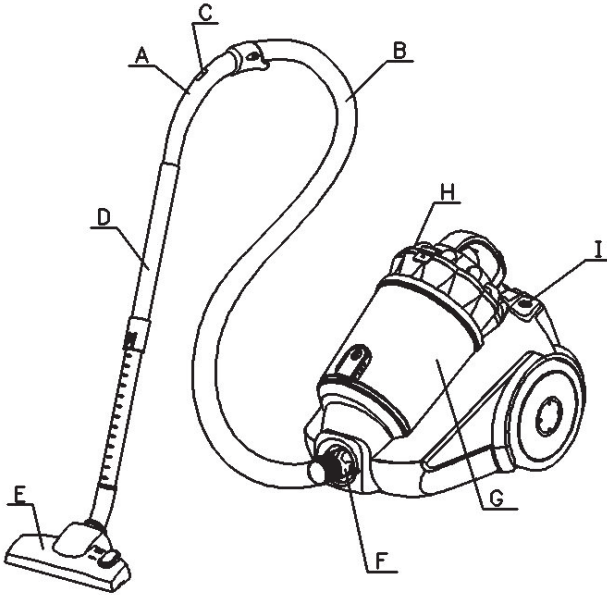

### Description

- A. Handle
- B. Hose
- C. wind-force adjuster
- D. Tube
- E. Floor brush
- F. Hose connector
- G. Dustbin
- H. Cord rewind button
- I. Power switch

## ASSEMBLING THE VACUUM CLEANER

### Removing the flexible tube

Remove the plug from the power socket. Tore the flexible tube, press the button on the end of the tube and pull the tube firmly from the air intake duct.

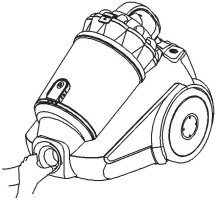

### Fitting the extension tubes and accessories

Fitting the extension tube  
The handle

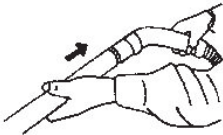

Fitting the extension tubes

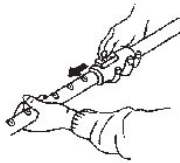

Fitting the accessories to the  
extension tube

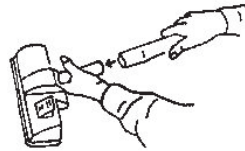

## INSTRUCTION FOR USE

1. Before using the appliance, unwind length of cable and insert the plug into the power socket. Do not extend the cable beyond the RED mark. To rewind the power cable, press the rewind button with one hand, and guide the other hand to ensure that it does not whip causing damage
2. Press the ON/OFF button to switch the appliance on.

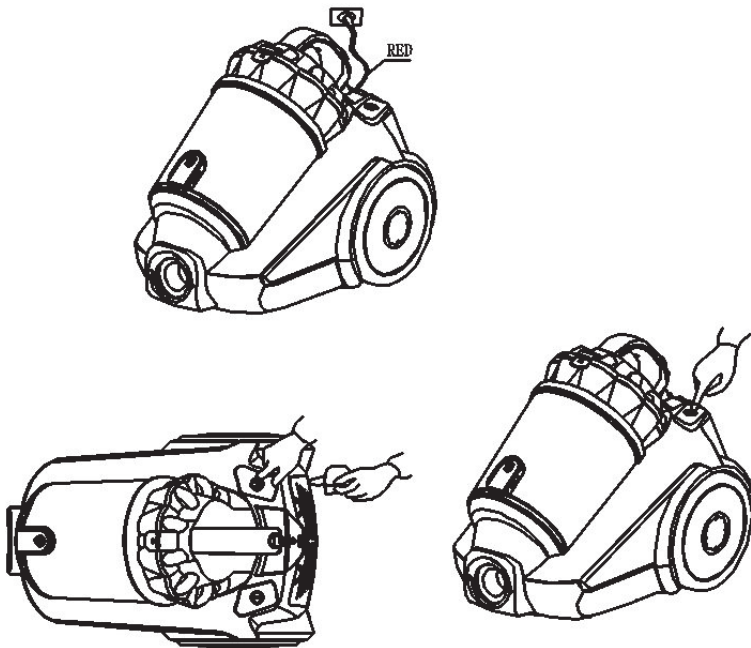

## Using the accessories

Dual-position carpet/floor brush.

Pos. 1: bristles extended, for hard floors

Pos. 2: bristles retracted for carpets

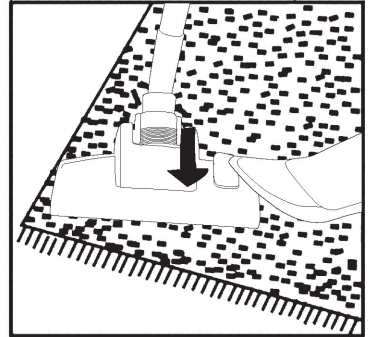
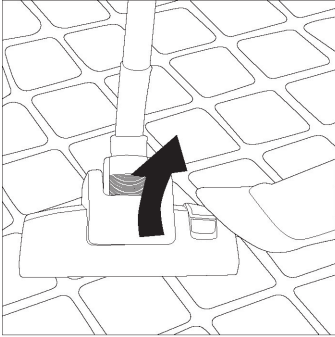

### . Narrow nozzle.

for cleaning radiator: corners. edges. drawers etc.

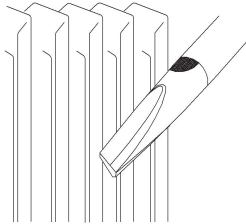

### Small bursh

for cleaning eurlains,shelves,books,inlaid furniture, lamps and other ceticate objects.

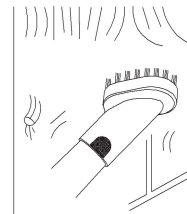

## MAINTENANCE

### Clean the dust

1. Lift the form cover and take out the dust cup.
2. Take out the foam form dust cup.
3. Clean off the dust inside the dust cup.

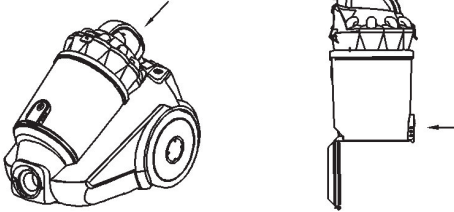

### Clean the air inlet foam filter regularly.

1. Remove the foam filter as shown.
2. Clean in a bowl of lukewarm or cold water, rinse to remove all dust particles.
3. Dry naturally in a well-ventilated space. Allow it to completely dry before refitting.



### Clean the HEPA outlet filter periodically.

1. Remove the HEPA filter as shown.
2. Clean in a bowl of lukewarm or cold water, rinse to remove all dust particles.
3. Dry naturally in a well-ventilated space. Allow it to completely dry before refitting.

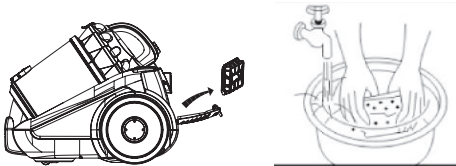



#### Warranty

We pride ourselves on producing a range of quality home appliances that are both packed with features and completely reliable. We are so confident in our products, we back them up with a 2 year warranty.

Now you too can relax knowing that you are covered.

Customer Helpline NZ: 0800 422 274

This Product is covered by 2 year warranty when accompanied by proof of purchase.





