

# LIVING&CO

## L+C 300W SMOOTHIE MAKER



**INSTRUCTION MANUAL**

**MODEL: LBL300W**

---

**AFTER SALES SUPPORT**

 **(NZ)** 0800 422 274



**Read these instructions carefully before using your blender, and keep it carefully.**

If you follow the instructions, your blender will provide you with many years of good service.

**SAVE THESE INSTRUCTIONS CAREFULLY**

## IMPORTANT SAFEGUARDS

1. Read all instructions before using.
2. Before using check that the voltage power corresponds to the one shown on the appliance nameplate.
3. Do not let cord hang over edge of table or counter.
4. Do not place on or near a hot gas or electric burner, or in a heated oven.
5. Do not operate any appliance with a damage cord or plug or after the appliance malfunction or has been damaged in any manner. Return the appliance to the nearest authorized service facility for examination, repair or adjustment.
6. If the supply cord is damaged, it must be replaced by the manufacturer or its service agent or a similarly qualified person in order to avoid a hazard .
7. Close supervision is necessary when any appliance is used by or near children.
8. Avoid contacting moving parts.
9. Blades are sharp, so handle carefully.
10. The use of attachment, including jar, jar lid, not

recommended or sold by manufacturer may cause fire, electric shock or injury.

11. The appliance cannot be used for blending hard and dry substance, otherwise the blade could be blunted.

12. Unplug from outlet when not in use, before putting on or taking off parts, and before cleaning.

13. To protect against risk of electrical shock do not put motor unit or power cord in water or other liquid.

14. Do not use outdoors.

15. Keep hands and utensils out of container while blending to reduce the risk of severe injury to persons or damage to the blender. A scraper may be used but must be used only when the blender is not running.

16. To reduce the risk of injury, never place cutter-assembly blades on base without jar properly attached.

17. Always operate blender with cover in place.

18. This appliance is not intended for use by persons (including children) with reduced physical, sensory or mental capabilities, or lack of experience and knowledge, unless they have been given supervision or instruction concerning use of the appliances by a person responsible for

their safety.

19. Children should be supervised to ensure that they do not play with the appliance.

20. Warning: never use hot liquids or run the appliance empty.

21. Warn: Potential injury from misuse.

22. Care shall be taken when handling the sharp cutting blades, emptying the bowl and during cleaning. Be careful if hot liquid is poured into the blender as it can be ejected out of the appliance due to a sudden steaming.

23. Switch off the appliance and disconnect from supply before changing accessories or approaching parts that move in use.

24. This appliance is intended to be used in household and similar applications such as:

- Staff kitchen areas in shops, offices and other working environments;
- Farm houses;
- By clients in hotels, motels and other residential type environments;
- Bed and breakfast type environments.

25. Save this instruction.

26. Never operate the appliance with wet hands.

27. It is recommended to have a residual current device (safety switch) installed by qualified electrician to

6

provide additional safety protection when using all electrical appliances.

# KNOW YOUR BLENDER

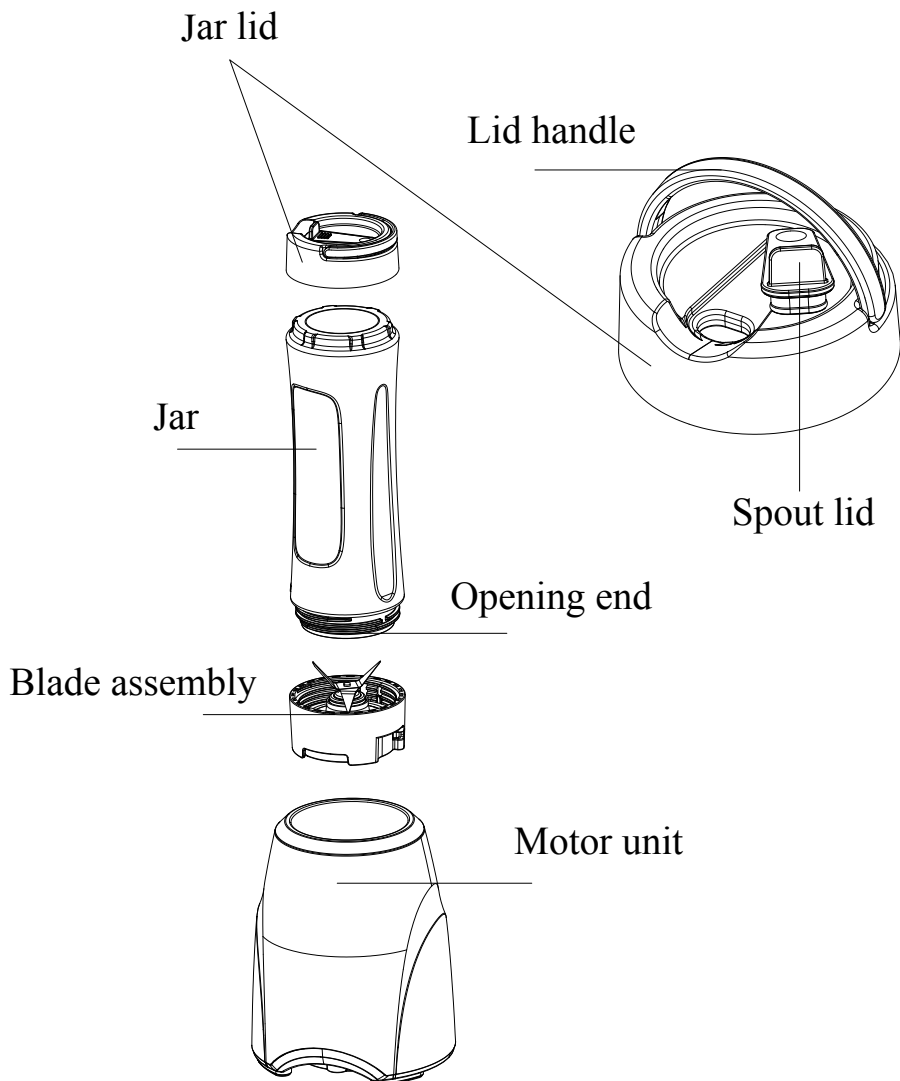



## BEFORE YOUR FIRST USE

Check that the accessories are complete and the unit is not damaged. Then pour a little water into the jar and mix according to the steps below for one or two times, then pour out, cleaning the jar and the jar lid thoroughly with warm water.

**Warning:** the blade is sharp, handle it carefully.

## OPERATION INSTRUCTION

1. Place the motor unit on the flat surface. Make sure the power outlet is unplugged.
2. Place the jar on a flat surface with the open ending facing up. Fill the jar with your favorite ingredients. Be sure not to fill ingredients exceed the 600ml marking.

**Note:** The appliance can blend ice cube, you can add proper amount of ice cube according to your desired.

**Note:** for optimal performance, place desired ingredients in the jar according to the following order: liquids, fresh ingredients, frozen fruit, yogurt and ice cream.

3. It must be noted that peeled or cored the fruit or vegetables and then cut it into small dices; general the size of fruit or vegetable dices is  $15 \times 15 \times 15$ mm, The seedcase of fruit or vegetable must be eat, such as carrot, strawberry, pineapple, lemon, grape, tomato.

**Note:** never use boiling liquids or run the appliance empty.

4. Assemble the blade assembly on the opening end of the jar by turning it in clockwise.

5. Upend the assembly of jar and blade assembly, and insert them into the motor unit, make sure arrow on the motor unit align with the blade assembly, then turn the assembly in clockwise to lock them.

6. Connect the plug to wall outlet and the appliance will start operating.

**Note:** The appliance can be operated without interruption for a maximum of 3 minutes, after which it should be allowed to cool down to room temperature.

7. When the operation is finished, turning the jar assembly in anti-clockwise to remove them and the appliance will

stop operating. Then unplug the power outlet.

8. Upend the jar assembly, hand the jar with one hand, and turning the blade assembly in anti-clockwise with the other hand to remove it.

9. Then assemble the jar lid on the jar. Take the jar with you throughout the day to stay hydrated. When you need to drink, you just need to open the spout lid to serve easily.

**Note:** after you have consumed your blended beverage, wash out the jar and reuse it throughout the day for water or other cold liquids.

## **CLEANING AND MAINTENANCE**

The Auto Clean feature can clean the blender and blade assembly easily, rapidly in complete safety.

-Pour a little warm soapy water into the jar and mix for a few seconds by plugging the power outlet.

- Remove the jar by turning it in anti-clockwise and rinse under running water.

-Wiping the outer surface of Motor Unit with a damp cloth.

**Warning:** Do not use abrasive cleaners. Never immerse the

## Motor Unit in water for cleaning

All parts except for the motor unit are dishwasher-safe. You can also wash the parts, except the motor unit, in warm, soapy water.

-Dry all parts and reassemble blade assembly to opening end of the jar and then place in the motor unit. Snap the jar lid on the other end of the jar.

If any problem has been encountered during use, never disassemble the Motor Unit by yourself, there are no user serviceable parts inside. Contact only the authorized service facility for examination and repair.

## ENVIRONMENT FRIENDLY DISPOSAL



You can help protect the environment! Please remember to respect the local regulations: hand in the non-working electrical equipments to an appropriate waste disposal center.

# LIVING&CO

## Warranty

We pride ourselves on producing a range of quality home appliances that are both packed with features and completely reliable. We are so confident in our products, we back them up with a 1 year warranty.

Now you too can relax knowing that you are covered.

Customer Helpline NZ: 0800 422 274

This Product is covered by 1 year warranty when accompanied by proof of purchase.