



KENSINGTON 350W CORDLESS VACUUM CLEANER



INSTRUCTION MANUAL **MODEL V18P01BP25EU**

CONTENT

	Page
Important Safety Instructions	2-3
Product Overview	4
Operation	5-10
Maintenance	11-14
Technical Data	15
Troubleshooting	16
Warranty	17

IMPORTANT SAFETY INSTRUCTIONS

This section contains safety instructions that will help protect from risk of personal injury or property damage. Failure to follow these instructions invalidates the granted warranty.

- This appliance complies with international safety standards.
- This appliance can be used by children aged from 8 years and above and persons with reduced physical, sensory or mental capabilities or lack of experience and knowledge if they have been given supervision or instruction concerning use of the appliance in a safe way and understand the hazards involved.
- Children shall not play with the appliance. Cleaning and user maintenance shall not be made by children without supervision.
- If the adapter or the appliance itself is damaged, do not use it. Contact an authorized service.
- Your mains power supply should comply with the information supplied on the rating plate of the appliance.
- Do not use the appliance with an extension cable.
- Prevent damage to the power cable by not squeezing, bending, or rubbing it on sharp edges.
- Do not touch the appliance or its plug when it is plugged if your hands are damp or wet.
- Do not pull the power cable when unplugging the appliance.
- Do not vacuum flammable materials and when vacuuming cigarette ash, make sure that it has cooled down.
- Do not vacuum water or other liquids.
- Protect the appliance from rain, humidity and heat sources.
- Never use the appliance in or near places where combustible or inflammable ambience or places are present.
- Unplug the appliance before cleaning and maintenance.
- Do not immerse the appliance or its power cable in water for cleaning.
- Do not attempt to dismantle the appliance.
- Use the original parts or parts recommended by the manufacturer only.
- Do not clean the particles such as cement, plaster and compressed paper in order to prevent the filter from being clogged and the motor being damaged.

IMPORTANT SAFETY INSTRUCTIONS

- Use the appliance only with the adapter supplied with.
- Do not use the appliance without filters, otherwise it can get damaged.
- If you keep the packaging materials, store them out of the reach of children.
- This appliance is not intended for use by persons (including children) with reduced physical, sensory or mental capabilities, or lack of experience and knowledge, unless they have been given supervision or instruction concerning use of the appliance by a person responsible for their safety.
- Children should be supervised to ensure that they do not play with the appliance.
- The appliance is only to be used with the power supply unit provided with the appliance.
- The adapter must be removed from the socket-outlet and the battery pack must be removed from the appliance before cleaning or maintaining the appliance
- If the adapter is damaged, it must be replaced by the manufacturer or its agent or similarly qualified person in order to avoid hazard.
- Keep fingers, hair and loose clothing from moving parts and openings whilst using the vacuum cleaner
- The battery must be removed from the appliance before it is scrapped;
- Please dispose of used batteries according to local laws and regulations.
- This appliance contains batteries that are only replaceable by skilled persons.
- The supply terminals are not to be short-circuited.

PRODUCT OVERVIEW

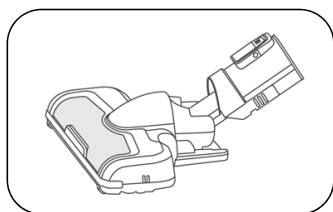

Floor head

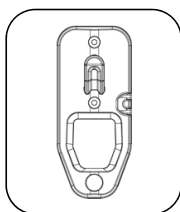

wall bracket

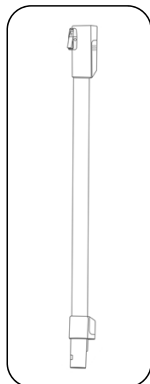

Extension tube

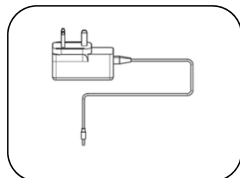

Adaptor / charger

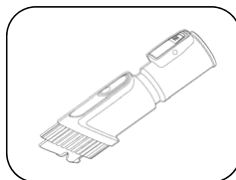

Combination nozzle

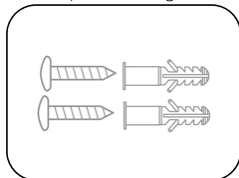

Wall fixings

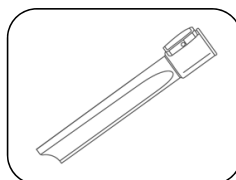

Crevice nozzle

Part identification

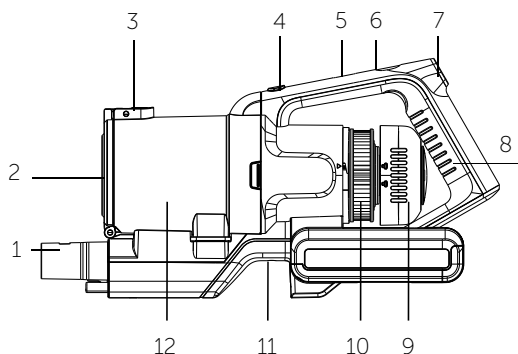

- 1 Accessory attachment point
- 2 Bottom lid
- 3 Dust release button
- 4 Dust container release button
- 5 Battery indicator light
- 6 Low/high mode button
- 7 Power on/off button
- 8 Handle
- 9 Filter cover
- 10 Post-motor filter
- 11 Easy rest nook
- 12 Dust container

Operation

Charging the Vacuum

This cleaner uses a rechargeable 25.2V Lithium battery suggest to charge fully before using for the first time. It takes approximately 3 hours.

1. Place the body of the cleaner onto a flat surface either a table or fit into the wall bracket.

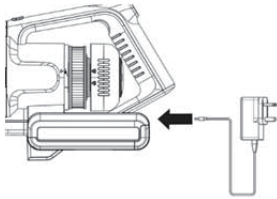

Fig. 1

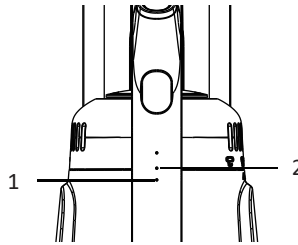

Fig. 2

2. Insert the adaptor cord into the DC jack at the end of the cleaner handle and plug the adaptor into the mains supply socket (fig.1).
3. The light indicator show the status (Fig 2):
Charging: Light 1 flash, light 2 off
Half charged: Light 1 on, light 2 flash
Fully charged: Light 1 & 2 on, then off in 10 mins
Low battery: Light 1 flash, light 2 off

Notes

- Light indicator 1(Fig 2) will flash when the battery is running low and needs to be recharged, If recharge not started, the vacuum will power off.
- Only charge or recharge the vacuum indoors.
- Do not recharge the battery when the air temperature is below 0°C or above 37°C.
- Batteries become hot after heavy use and will become difficult to charge. Allow to cool and wait about an hour between recharges.

Operation

Assembling your vacuum

Bringing it all together

- Safety**
- Before drilling into wall surface, check for hidden cables or pipes.
 - Wear safety goggles and dust mask when drilling.
 - The use of a residual current device (RCD) is recommended when working with power tools.

- Tools required**
- Drill fitted with a 6mm masonry drill bit
 - Screwdriver
 - Pencil
 - Ruler
 - Spirit level

1. Choose a suitable location for the wall bracket away from areas where it will get wet or knocked and close to a socket. Check that the charge cable will reach the mains socket (180cm distance max) and that there is sufficient space above and below the bracket (approx. 120-125cm below) for the fully assembled vacuum cleaner be inserted. No part of the vacuum cleaner should touch the floor when fitted into the bracket (fig 6).

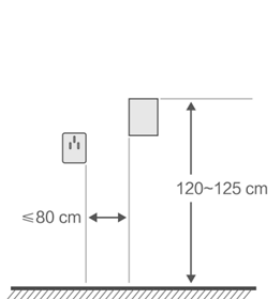

Fig. 4

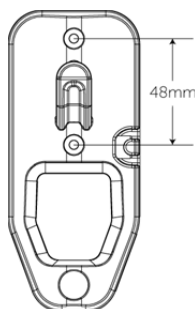

Fig. 5

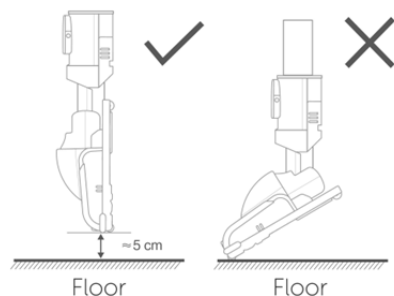

Fig. 6

Operation

2. Place the bracket in the desired position and using a pencil, mark the position for the two screw holes. Using a ruler, draw a line joining the points marked for the two screws and using a spirit level, check that it is on the same level.
3. If fixing to a masonry wall, use a masonry drill bit, drill holes to a depth of 30mm and insert the wall plugs.
4. If fixing to ceramic tiles, use a tile and glass drill bit to drill through the tile and then drill holes to a depth of approximately 32 mm using a masonry drill bit. Insert the wall plugs beyond the depth of the tile.
5. Hold the bracket into position, align the fixing holes in the bracket with the wall plugs and insert the screws until the bracket is held firmly into position
6. Fit the nozzles onto their storage posts, and insert the assembled vacuum cleaner into the bracket (fig.7).

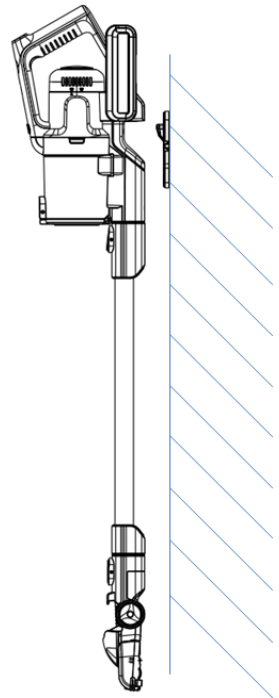

Fig. 7

Notes:

- If fixing the bracket to timber, follow the directions above, but only drill a small pilot hole for each screw and do not use wall plugs. This fitting is not suitable for mounting onto doors.
- If fixing to hollow plasterboard walls, use a drill bit suitable for wood and use wall anchors suitable for cavity walls. For maximum strength locate into wall studs and cross braces if possible.

Operation

Assembly

1. Insert the extension tube onto the body of the vacuum as shown (fig. 8) and push to secure, a click will be heard.
2. Push fit the floor head onto the extension tube (fig. 8), a click will be heard. The crevice nozzle and combination nozzle can be fitted in place of the floor head.

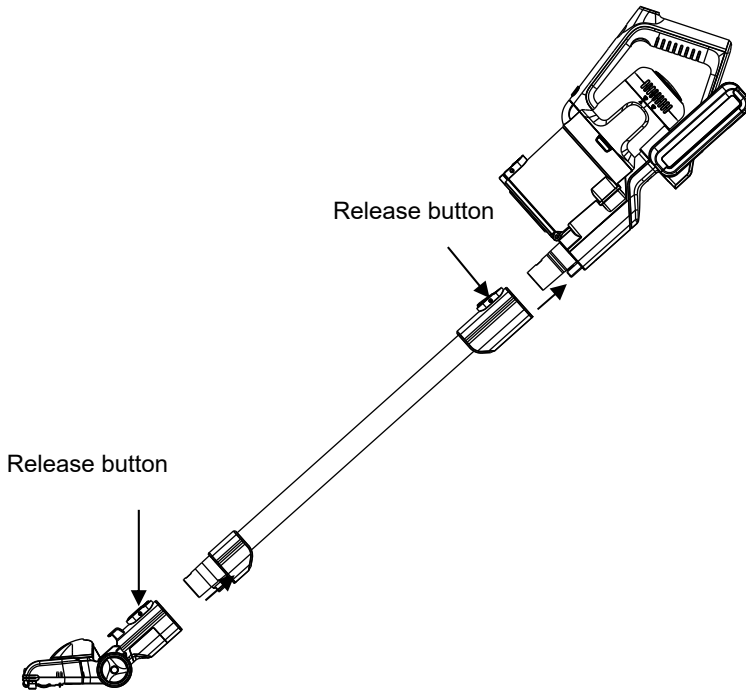

Fig. 8

3. Alternatively do not use the extension tube and fit the crevice nozzle or combination nozzle directly onto the body of the vacuum cleaner (fig. 9). The floor head can be fitted in a similar manner, but if using in this configuration **ensure hands are kept away from the floor head during operation** – due to a potential entrapment hazard.

Operation

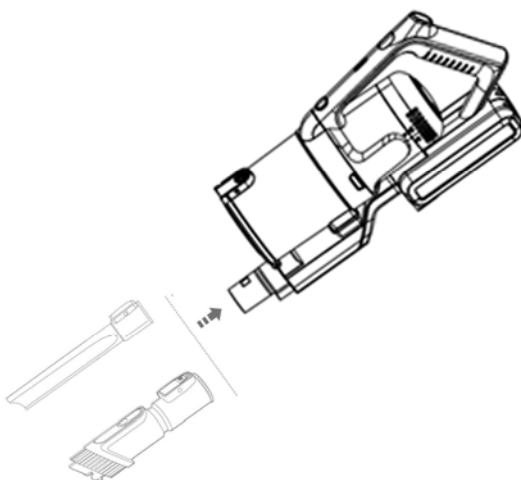
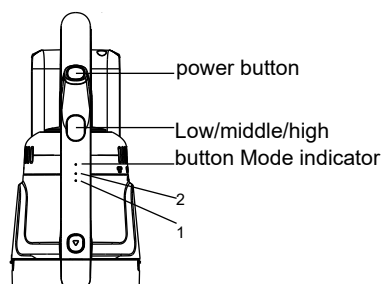

Fig. 9

4. To remove the all parts press the release button and accessories firmly pull apart.

Getting started

1. Fit the correct nozzle for the cleaning application, ensure that the battery has sufficient charge.
2. Click power button once to start, the LED lights on the floor head(if fitted) will illuminate and the vacuum cleaner will start with middle mode. Use Low/Middle/High button to switch between two modes. The vacuum cleaner may be used from 9 mins with high mode, 25 mins Mid mode and 45 mins with low mode.
3. Click the power button again to stop the vacuum cleaner after use
4. Store the vacuum in the wall bracket when not in use.



Operation

Nozzle use

The table below is a use guide for the accessories supplied but there is no hard and fast rule when it comes to vacuuming and the use of each accessory. Use whichever attachment seems to accomplish the job quickly and easily without damaging the surface to be cleaned.

Nozzle	Cleaning area							
	Floor & carpets	Furniture	Between cushions	Curtains	Stairs	Walls	Skirting edges	Radiators
Floor head	✓				✓			
Combination tool - Upholstery brush		✓		✓	✓	✓		
Combination tool - furniture brush		✓		✓	✓	✓		
Crevice tool		✓	✓		✓		✓	✓

CAUTION: One of the most common reasons for poor vacuum performance or for the vacuum switching off before the rated run time has been reached, is due to the inlet filter being blocked. Whilst this can appear to be clean (from the outlet side as viewed when opening the dust container), this can be largely restricted internally after several hours of use.

When the filter is clogged, this directly affects the airflow of the motor and the suction performance. When the airflow is restricted, this increases the operating temperature of the suction motor. The vacuum incorporates over temperature protection circuitry, to switch off automatically if a pre-set internal temperature is reached. This is done to protect the vacuum from permanent damage. If you find the vacuum is regularly switching off prematurely, this may be an indication that there is an airflow restriction in the pipe / accessories or filter.

In order to maintain good performance, the filter must be regularly removed and cleaned as detailed in the maintenance section.

MAINTENANCE

Disconnect the charger from the vacuum cleaner before carrying out cleaning and maintenance.

To ensure your vacuum cleaner works at optimum efficiency, keep the ventilation holes and vacuum cleaner surface free from dirt.

Ensure that the dust container is emptied and the air filters are washed regularly.

1. Wipe the outside of the vacuum cleaner and accessories with a damp (not wet) cloth and then wipe dry. Do not use detergents, solvents or abrasives as these may scratch or damage the surface.
2. Never immerse the vacuum cleaner, battery or charger in water.
3. When not in use, store in a cool, dry place.

Emptying the dust container

1. When the dust container reaches the MAX line marked on the dust container (Fig. 11) or when the suction power is reduced, it is time to empty the dust container.
2. Position the dust container over a refuse bin, then press the lever at the front of the container to open the base (Fig. 12) and empty the container. Gently tap the container against the side of the bin to remove any stubborn dust.

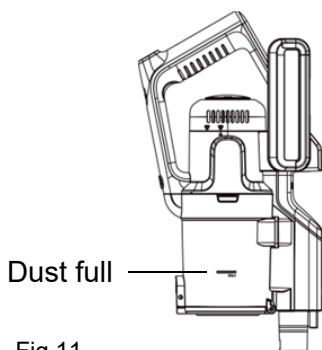

Fig.11

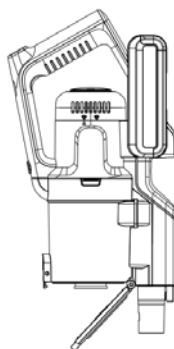

Fig.12

3. The inside of the dust container may be wiped clean with a damp cloth. Dry with a soft dry cloth before closing the flap. A click will be heard when it is correctly engaged.

MAINTENANCE

Cleaning the filters

1. The frequency that the filters should be cleaned will depend on appliance usage. For maximum efficiency the filter within the dust container should be cleaned **every time the dust container is emptied** and the exhaust filter at the top every three months.
2. Click the dust container release button, located on the front of the handle just above the dust container and pull dust container out (Fig. 13)
3. Lift out the cyclone from dust container (Fig. 14), lift out pre-motor filter and shake off dust frequently. Every three months rinse filter and dry thoroughly (Fig. 15), turn the filter assembly head clockwise to disassembly the cyclone filter (Fig 16), wash with running water, and **ensure it is completely dry** before next use (Fig. 17).

Pull out Press

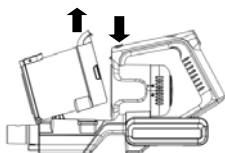

Fig. 13

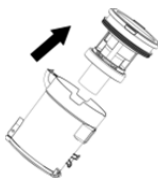

Fig. 14

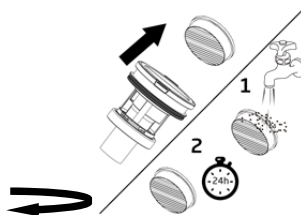

Fig. 15

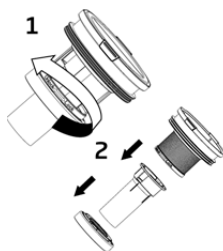

Fig. 16

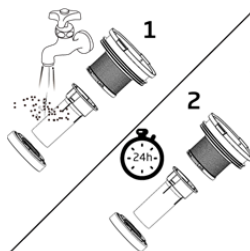

Fig. 17

CAUTION: Failure to regularly clean the main dust filter will result in loss of suction and reduced operating times.

MAINTENANCE

4. Tap the filter against a dustbin to remove most of the dust and then wash the filter in cold running water until the water runs clear. Allow to air dry fully. Using a damp or wet filter will reduce the suction and damage the motor.
5. The filter assembly can also be washed under running water if needed.
6. When the filter and assembly are completely dry, reverse the above steps and refit the filter into the dust container and close the flap. In each case turn in the direction of the locked padlock symbol (Fig. 18).
7. To clean or replace the post-motor filter, turn the cover anticlockwise and lift off the cover (Fig. 19), remove the filter (Fig.20), wash and dry the filter in accordance with step 4.
8. Refit the filter and cover onto the cleaner.

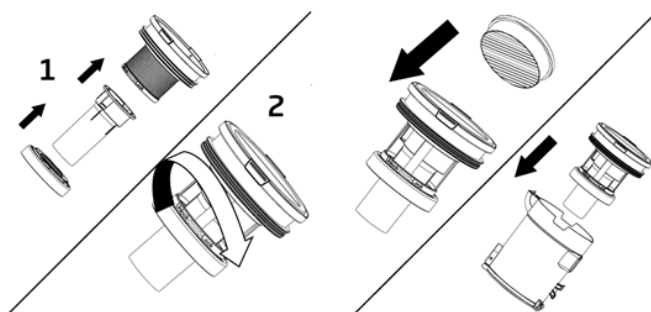

Fig. 18

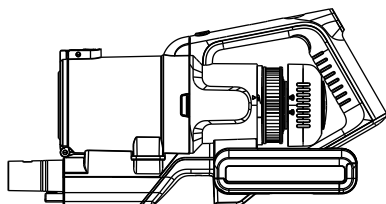

Fig. 19

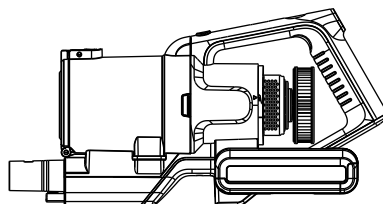

Fig. 20

CAUTION: Failure to regularly clean the main dust filter will result in loss of suction and reduced operating times.

MAINTENANCE

Cleaning the brush

1. The frequency that the brush should be cleaned will depend on appliance usage. Always stop the vacuum and clean the brush head if the indicators turn white or if the floor head brush stops rotating.
2. Remove the floor head from the cleaner (Fig. 19).
3. Push the small lever at the side of the brush in the direction of the front of the floor head and lift off the retaining plate (Fig. 20).
4. Lift out the roller brush (Fig. 21) and remove any thread, fluff or other obstructions. The brush roller can also be washed under running water if needed. Allow to fully dry.
5. Refit the bush roller and secure into position by fitting the retaining plate.

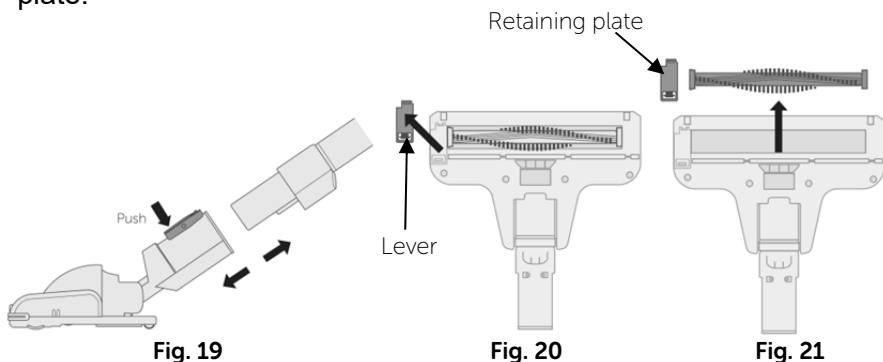

NOTE: The motorised brush head incorporates an automatic shut off protection device. In the event of entrapment, where an object is drawn into and jams the rotating brush, the power to the brush motor will switch off to prevent further damage. If jamming occurs, switch the vacuum off, remove the trapped item, allow the vacuum to cool and reset for approximately 10 minutes before further use.

TECHNICAL DATA

Motor Power: 350W

Adaptor Input: 100-240V ~ 50-60 Hz 0.8A

Output: 25-29V~ 0.8A

Battery Type: 25.2V, 2000mAH, Li-ion battery

Charging Time: Approx. 3 hours

Dust Bin Volume: 0.65L

Running Time: High Speed Mode: ≥9mins

Mid Speed Mode: ≥25mins

Low Speed Mode: ≥45mins

Handheld (without floor brush attachment)

Low Speed mode : ≥50mins

WARNING: For the purposes of recharging the battery, only use the detachable supply unit MC2505A-S provided with this appliance.

Follow the instructions by paying attention to all the information and warnings in the user manual.

TROUBLESHOOTING

Common failure	Possible cause	Solutions
The vacuum doesn't work	Product is powered off or battery is low	Please charge the product before use
	Product suction port is blocked.	Clean inlet tube
Suction is too weak	Dust collection container & filter assembly is full	Clean the dustbin and filters
	Rolling brush is wrapped around the hair and other objects	Clean roller brush
	Battery is not fully charged	Ensure correctly connected to the charger
Motorised brush head does not turn	Foreign object has been caught	Remove the obstacle
	Temporary jamming has caused protection device to operate	Switch off and allow to cool for 10 minutes
Vacuum cleaner performance is poor	Too many obstacles in the cleaning area	Manually remove obstacles
	Dust filters are full	Clean the filters
	The correct nozzle has not been selected	Use appropriate nozzle
Product cannot be charged	Charger not correctly connected	Check connections
	Mains supply socket is faulty or not switched on	Check supply socket switch or use an alternative
	Situation still remains	Please contact after sales support
Vacuum switches off before rated run time is reached	Battery was not fully charged	Check connections and fully charge
	A blockage has occurred in the Filter, pipe or accessories	Check for obstructions and wash, dry Filter- see maintenance section
	Situation still remains	Please contact after sales support



Warranty

We pride ourselves on producing a range of quality home appliances that are both packed with features and completely reliable. We are so confident in our products, we back them up with a 3 year warranty.

Now you too can relax knowing that you are covered.

Customer Helpline NZ: 0800 422 274

This Product is covered by a 3 year warranty when accompanied by proof of purchase.

IM Version 13 - January 2023