

**ditto**  
tandem stroller

instruction  
MANUAL



Illustrations and designs may vary.

follow us on    
 [motherschoice.com.au](http://motherschoice.com.au)

the only choice

# contents

<i>assembling the stroller</i>	<i>pg.</i>
Components list .....	4
Opening stroller .....	5
Installing front wheels .....	6
Installing rear wheels .....	7 - 8
Attaching front canopy .....	9
Attaching rear canopy .....	10
Attaching shopping basket .....	10
 <i>using the stroller</i>	
Operating rear brakes .....	11
Front swivel locks .....	11
Folding / unfolding .....	12
Adjusting backrest .....	13
Extending canopies .....	14
Peek-a-boo window .....	15
Securing your child .....	16
Tether strap .....	17
Raincover .....	17
Removing brake bar lever .....	18
Removing rear wheels .....	19
 <i>caring for your stroller</i>	
Care and maintenance .....	20
Notes .....	21 - 22
Product registration .....	23
 <i>contacts</i>	
Customer service .....	24

These instructions detail the safe use, assembly and maintenance of your product. Please read these instructions carefully and ensure that they are followed at all times. Failure to do so could result in serious injury or death.

---



## WARNING

- **FOLLOW THE MANUFACTURE'S INSTRUCTIONS.**
- **PUT ON ALL BRAKES WHENEVER YOU PARK THE STROLLER.**
- **DO NOT LEAVE CHILDREN UNATTENDED.**
- **DO NOT CARRY EXTRA CHILDREN OR BAGS ON THE STROLLER, UNLESS IT IS AN APPROVED ACCESSORY.**
- **MAKE SURE CHILDREN ARE CLEAR OF ANY MOVING PARTS IF YOU ARE FOLDING, UNFOLDING OR ADJUSTING THE STROLLER, OTHERWISE THEY MAY BE INJURED.**
- **THE FRONT SEATING POSITION IS NOT RECOMMENDED FOR A CHILD UNDER 6 MONTHS OLD.**
- Secure the child in the harness at all times.
- Ensure that the safety harness is adjusted firmly but comfortably to the child's body.
- A harness can form loops that may be a strangulation hazard. Never leave harness straps connected when not fitted to a child in the stroller.
- Check that the stroller is fully erected and all safety locks are engaged before placing a child in the stroller, otherwise they may be injured.
- Do not allow children to stand on the seat or footrest.
- Do not attempt to lift the stroller by the bumper bar or child tray, if it has one.
- Do not run or jog with this stroller.
- Remove child from stroller before going up or down stairs or escalators.
- Do not use the stroller near an open fire, barbecue or exposed flame.
- Engage front wheel swivel locks when travelling on rough or uneven surfaces.
- This product is not intended for commercial use.
- Regularly inspect the stroller for any parts that are loose, broken, torn or missing. Attend to the problem as soon as it is observed.
- Use only those accessories which are supplied by Dorel Australia Pty Ltd and approved for use with this stroller.
- Use the tether strap to prevent the stroller rolling away.
- Keep children away from the stroller when unfolding and do not let them play with the folded stroller.
- Total weight of the child using this stroller should not be more than **17kg**, per seat.
- Shopping basket capacity should not be more than **2kg**.
- Maximum weight for the rear canopy pocket is **0.2kg**.

# ditto

## tandem stroller

### components list



**A** Handles  
(both sides)

**B** Upper frame locks  
(both sides)

**C** Tether strap

**D** Rear canopy lock  
(both sides)

**E** Storage strap

**F** Front canopy lock  
(both sides)

**G** Shopping basket

**H** Lower frame lock

**I** Rear brake

**J** Rear wheels  
(both sides)

**K** Front wheels  
(both sides)

**L** Front wheel swivel locks  
(both sides)

**M** Footrest

**N** Safety harness

**O** Crotch guard

**P** Harness pads

**Q** Front seat

**R** Front canopy

**S** Rear canopy

**T** Peek-a-boo window

# ditto

## tandem stroller

### assembling stroller



### step 1: opening stroller

- If the stroller has a security tie, please remove it.
- Place the stroller on the floor with the handles facing downwards.
- Release the storage strap (Figure 1a).
- Lift the handle upwards away from the front legs (Figure 1b), while engaging the lower frame lock with foot (Figure 1c).
- Continue this action until the frame is fully open.
- Engage the lower frame lock by pressing it down into the locked position (Figure 1c).

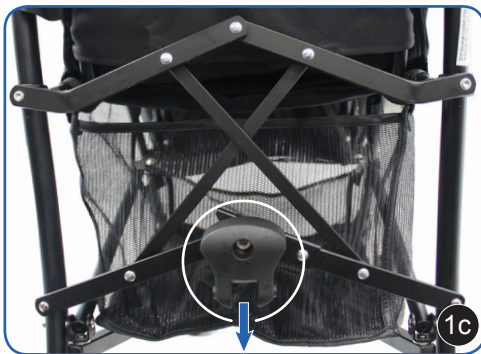

press down  
with foot

### mother's choice tip...

Ensure that the stroller is fully assembled before placing a child in it.

# ditto

## tandem stroller

### assembling stroller



### Step 2: installing front wheels

- Ensure that the arrow (Figure 2a) points upward.
- Also ensure that the red swivel lock is positioned correctly, with the lock facing in a forward direction (as per Figure 2c).
- Insert the front wheel assembly onto the frame tube (Figure 2d).
- The wheel assembly will “click” when installed properly.
- Repeat for other side.

# ditto

## tandem stroller

### assembling stroller

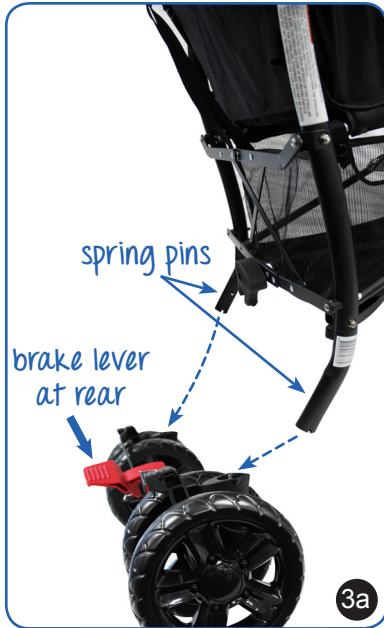

### step 3: attaching rear wheels

- Position each side of the axle assembly over the corresponding ends of the rear wheel legs of the frame (Figure 3a).
- Push the wheels onto the legs (Figure 3b).
- Ensure the wheel assembly is locked by checking that the metal pin passes through hole in wheel assembly (Figure 3c).





# ditto

## tandem stroller

### assembling stroller

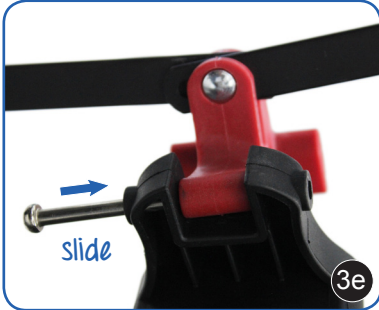

### step 3: attaching rear wheels (cont'd)

- Align the brake bar lever located on the centre of the wheel axle with the frame lock, and push the brake bar lever into the frame lock (Figure 3d).
- Insert the locking pin into the hole on the side of the frame lock (Figure 3e).
- Make sure the locking pin slides through the slot in the red brake bar lever.
- Insert the locking clip into the locking pin (Figure 3f).



**ditto**

**tandem stroller**

*assembling stroller*



*Step 4: to fit the canopies*

*rear canopy*

- Position and slide the mounts on both sides of the hinge moulding to enable the grooves to snap onto the guides and push down to lock tab in position (Figure 4a).
- Position the back flap of the canopy over the support bar between the handle frame.
- Pass the sides of the back flap around the handle frame on both sides (Figure 4b).
- Attach the velcro tabs to the frame on both sides (Figure 4c).

# ditto

## tandem stroller

### assembling stroller

#### step 4: to fit the canopies (cont'd)

##### front canopy

- Position and slide the mounts on both sides of the hinge moulding to enable the grooves to snap onto the guides and push down to lock tab in position (Figure 4d).
- Attach the velcro tabs on the back flap to the velcro tabs on the underside of the canopy on both sides (Figure 4e).



#### step 5: attaching shopping basket

- The shopping basket attaches to the frame with press stud clips loops around the tubes under the seat.
- There are three loops each side (Figure 5), repeat for both sides.



# ditto

## tandem stroller

### using stroller

#### operating brakes

- TO LOCK: Press the brake lever downwards (Figure 7a).
- TO UNLOCK: Push the brake lever upwards (Figure 7b).

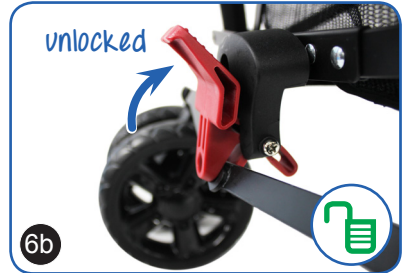

#### operating front swivel locks

- TO LOCK, align the swivel lock button with the frame and push upwards (Figure 7a).
- TO UNLOCK, push the swivel lock button downwards (Figure 7b).

# ditto

## tandem stroller

### using stroller



## folding/unfolding stroller

- Apply rear brakes.
- Position the backrest of the rear seat in the upright position.
- Ensure the rear canopy is fully back, and the front canopy is folded forward towards the bumper (Figure 8a).
- Unlock both front swivel wheels to allow them to rotate freely.
- Lift up the lower frame lock with one foot (Figure 8b).
- While pulling back the upper frame lock levers (located on each side of the upper handles, Figure 8c), push the handles forward to allow the stroller to fold (Figure 8d).
- Continue this action until the stroller is folded.
- Engage the storage strap (Figure 8e).



# ditto

## tandem stroller

### using stroller

#### to adjust backrest (rear seat only)

- The backrest adjuster is positioned behind the rear seat (Figure 9b).
- Slide the adjuster button with your thumb and adjust the backrest to the desired position (Figure 9a).

#### *mother's choice tip...*

Always ensure the backrest is in upright position before folding stroller.



backrest adjuster



# ditto

## tandem stroller

### using stroller



### extending canopy

- Extend each canopy out (Figure 10a), and lock into place by pressing canopy lock down on both sides (Figure 10b).
- To retract the canopy, lift the canopy lock on both sides and close.

### mother's choice tip...

Always ensure both canopies are retracted before folding stroller.



# ditto

## tandem stroller

### using stroller



### using peek-a-boo window

- To reveal peek-a-boo window, ensure canopy is first fully extended.
- Lip flap from velcro tab (Figure 11a) and roll back.
- Secure with toggle (Figure 11b).

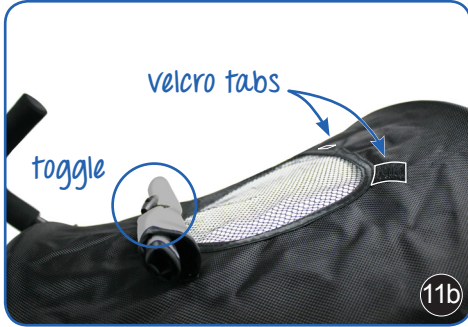



# ditto

## tandem stroller

### using stroller

#### securing your child

- The harness strap can be adjusted by moving each strap's slider.
- The buckle is released by squeezing the buckle tongues together.

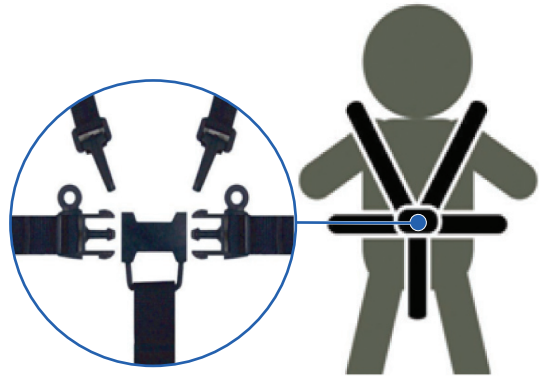

### **WARNING**

Use this harness at all times.

A five-point harness is provided to secure your child.

When not in use disconnect shoulder straps from the waist strap and buckle.

# ditto

## tandem stroller

### using stroller

#### tether strap

- Whenever a child is in the stroller and brakes are NOT engaged, the large loop should be around your wrist (Figure 12).



### WARNING

Use this strap to stop the stroller rolling away.



#### attaching raincover

- Spread the raincover over the stroller and underneath the handles (Figure 13).
- On each side underneath the handles, attach the three velcro tabs (both sides).
- Pull the front of the raincover over the front seat's legrest.
- On each side below the front seat, attach the velcro loops around the stroller frame.



**ditto**

**tandem stroller**

*using stroller*

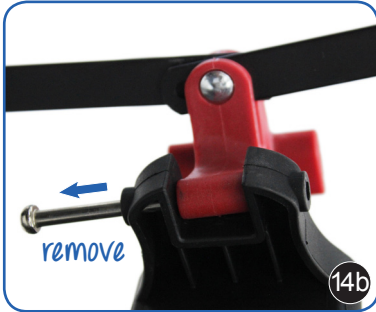
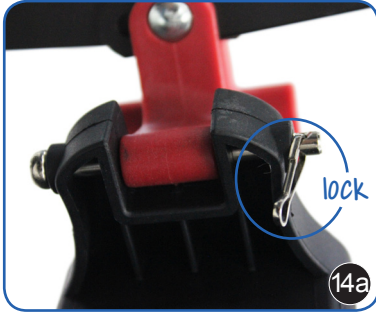

### *removing brake bar lever*

- To remove brake bar lever, detach locking clip (Figure 14a).
- Slide the locking pin out from the frame lock and red brake bar lever (Figure 14b).
- Brake bar lever is now free to remove (Figure 14c).

**ditto**

**tandem stroller**

*using stroller*

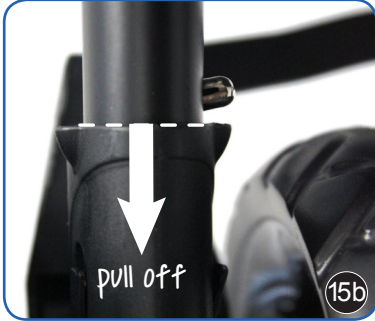
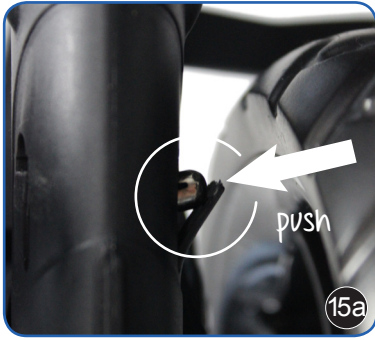

### removing rear wheels

- Ensure the brake car lever is removed before removing rear wheels (see page 18).
- To remove rear wheel assembly, push the metal pin inwards (Figure 15a) to release lock, then pull wheel off (Figure 15b).

#### *mother's choice tip...*

If you have trouble pushing the metal pin inwards, try using a pen or screwdriver.

# ditto

## tandem stroller

### *care and maintenance*

- Always store in a clean and dry place.
- Clean the frame by wiping with a damp cloth.
- Do not use abrasives, bleach or strong detergents.
- Spot clean fabrics with warm water and mild soap.
- Ensure fabric is dry before storing.
- Occasionally clean and lubricate wheels and axles with a light lubricating oil.
- Regularly check for loose parts and tighten when required.
- Damaged or broken parts should be immediately replaced.







## *mother's choice tip...*

Visit us online to register your new Mother's Choice product.



follow us on    
[motherschoice.com.au](http://motherschoice.com.au)

[www.motherschoice.com.au/product-registration](http://www.motherschoice.com.au/product-registration)

## *benefits of registration*

- Your safety - allows us to contact you with important product notifications.
- Confirmation of ownership - provides a record in case of product loss or theft.
- Improved product development - helps us continue to design products that meet your needs.

*to prevent loss or fading,  
please attach your receipt here:*

[motherschoice.com.au](http://motherschoice.com.au)

DOREL AUSTRALIA PTY LTD  
655-685 Somerville Road  
Sunshine West Victoria 3020  
Email: [customerservice@dorel.com.au](mailto:customerservice@dorel.com.au)  
Phone: 1300 809 526  
Hours: 8:30 am - 5:00 pm Monday to Friday

IGC DOREL NEW ZEALAND LTD  
14 Sir William Avenue  
East Tamaki Auckland 2013  
Email: [customerservice@igc.co.nz](mailto:customerservice@igc.co.nz)  
Phone: 0800 628 000 (toll free)  
Hours: 8:00 am - 5:00 pm Monday to Friday

015747 - Mother's Choice Ditto Tandem Stroller - 01 / 15



Specifications are subject to change without notice.  
Copy or reproduction without permission is prohibited.  
© 2013 Dorel Australia Pty Ltd. All Rights Reserved.

[www.dorel.com.au](http://www.dorel.com.au)